

5th January 1910

The Personal
Representatives of
Mr W. H. Wilson deceased
to
Mr Tom Pearson
Conveyance and
Bargain & Sale.

Stamp
17/6

This Indenture made the Fifth day of January one thousand nine hundred and ten Between Harold Bryan of 56 Ryehill cottages Kirkewhite Street in the City of Nottingham Police constable and Thomas Henry Wilson of 15 Rutland Avenue in the county Borough of Leicester Mechanic of the one part and Tom Pearson of Liddington in the county of Rutland Butcher of the other part
Whereas William Henry Wilson late of 56 Ryehill cottages Nottingham aforesaid was at the time of his death seized of the freehold hereditaments hereinafter conveyed in unencumbered ^{in possession and also seized in unencumbered fee simple} of the copyhold hereditaments hereinafter described according to the custom of the Manor of Liddington with Baldercott in the county of Rutland And whereas the said William Henry Wilson by his last Will and Testament dated the fourteenth day of June one thousand nine hundred and nine appointed the said Harold Bryan and Thomas Henry Wilson to be Executors thereof and after directing payment of his debts funeral and testamentary expenses gave devised and bequeathed unto his six children (therein named) in equal shares all his property and investments And directed the property to be sold and the money equally divided between the said children And whereas the said William Henry Wilson died on the fifteenth day of June one thousand nine hundred and nine without having altered or revoked his said Will which was duly proved in the Principal Probate Registry of the High Court of Justice on the fourth day of September one thousand nine hundred and nine by both the Executors therein named And whereas the said Harold Bryan and Thomas Henry Wilson as the personal Representatives of the said William Henry Wilson deceased have agreed to sell to the said Tom Pearson the said freehold hereditaments free from incumbrances at the price of one hundred and ten pounds. And whereas the said Harold Bryan and Thomas Henry Wilson as such personal representatives as aforesaid pursuant to the direction for sale contained in the said Will as aforesaid have agreed to

5th January 1910.

sell to the said Tom Pearson the said copyhold hereditaments
 free from incumbrances at the price of Fifty pounds Now this
 Indenture witnesseth that in consideration of the sum of
 One hundred and ten pounds to the said Harold Bryan, and
 Thomas Henry Wilson paid by the said Tom Pearson (the
 receipt whereof the said Harold Bryan and Thomas Henry
 Wilson hereby acknowledge) the said Harold Bryan and Thomas
 Henry Wilson as the personal representatives of the said William
 Henry Wilson deceased hereby convey unto the said Tom Pearson
 All that close piece or parcel of land called "The Brand Bottom
 close" containing Two acres one rood and twenty eight perches or
 thereabouts situate in Liddington aforesaid bounded on the
 Northeast by a private road on the southeast by an allotment to
 William Clarke and now or late belonging to Thomas William
 Wright on the southwest by an allotment belonging to the
 Marquis of Exeter and on the Northwest by an allotment belonging
 to the Ecclesiastical Commissioners and now in the occupation of
 the said Tom Pearson To hold unto and to the use of the said
 Tom Pearson in fee simple. And this Indenture, also witnesseth
 that in consideration of the sum of Fifty pounds
 now paid to the said Harold Bryan and Thomas Henry Wilson
 on or before the execution of these presents by the said Tom Pearson
 (the receipt whereof the said Harold Bryan and Thomas Henry
 Wilson hereby acknowledge) They the said Harold Bryan and
 Thomas Henry Wilson as the personal representatives of the said
 William Henry Wilson deceased and in pursuance of the direction
 for sale contained in the said Will and of every or any power or
 authority enabling them in this behalf do hereby bargain sell
 and appoint unto the said Tom Pearson All that cottage or
 tenement (formerly called the half part of a cottage or tenement
 with the yard garden and appurtenances thereto belonging
 situate in Liddington aforesaid within the said Manor formerly
 in the occupation of John Turrell and Mary Ann Freeman
 then of James Muggleton then of Mrs. Wheatle late of the said
 Tom Pearson and now of Braunston held by copy of
 Court Roll of the said Manor at the yearly rent of two pence

28th December 1916.

and to which the said Testator was admitted at a special court held in and for the said Manor on the fourth day of March one thousand nine hundred and one. To hold the same unto and to the use of the said Tom Pearson his heirs and assigns at the Will of the Lord according to the custom of the said Manor by the rents suits and services therefor due and of right accustomed. In witness whereof the said parties hereto have hereunto set their hands and seals the day and year first above written. Harold Bryan & Thomas Henry Wilson & signed sealed and delivered by the above named Harold Bryan in the presence of William C. Has. Honabin 48 Ryehill cottages, Kirkwhite St. Nottingham Police constable or signed sealed and delivered by the said Thomas Henry Wilson in the presence of George Hulme solr. clerk to Messrs. G. Stevenson & Son, Solicitors Leicester.

Examined by me,

Thomas Mills
Steward.

The Manor of Liddington
with baldecott
in the county of Rutland

The Admission of Tom Pearson
out of court at Stamford on the twenty eighth
day of December one thousand nine hundred
and sixteen Before Richard Mills English Steward of the courts
of the Most Honorable William Thomas Brownlow Marquis of
Exeter Baron of Burghley Lord of the said Manor.

Tom Pearson under a
Deed of appointment
from Messrs. Harold
Bryan and Thomas
Henry Wilson.

Be it remembered that on the twenty eighth day of December
one thousand nine hundred and sixteen Tom Pearson of the
Feast Ground barbrook near Sheffield in the county of York Butcher
by Frederick Andrews his Attorney came before Richard Mills
English Steward of the courts of the said Manor and produced a
certain Deed of conveyance and appointment dated the fifth day
of January one thousand nine hundred and ten made between
Harold Bryan and Thomas Henry Wilson of the one part and the
said Tom Pearson of the other part and prayed that the same might
be enrolled on the court Rolls of the said Manor and the same has

I certify that this Deed
was stamped with a stamp
of seven shillings & six pence
Thomas Mills
Steward.

Admitted to the Manor
9.1.17

Re
Fin
Fran
Arth
and
Se

3rd. January 1917.

accordingly been enrolled by which Deed All that cottage or tenement (formerly called the halffpart of a cottage or tenement) with the yard garden and appurtenances thereto belonging situated in Liddington aforesaid within the said Manor late in the occupation of the said Tom Pearson and now of Branston held by copy of court Roll of the said Manor under the yearly rent of two pence and to which William Henry Wilson deceased was admitted as tenant on the fourth day of March one thousand nine hundred and one upon the surrender of Charles Hart and others was bargained sold and appointed unto and to the use of the said Tom Pearson his heirs and assigns for ever at the Will of the Lord according to the custom of the said Manor **Now** the said Tom Pearson this day by his said Attorney comes and prays to be admitted Tenant to the hereditaments and premises so bargained sold and appointed to him as aforesaid **Now** the Lord by his said Steward granted seizin by the Rod **To Hold** the hereditaments aforesaid with the appurtenances unto the said Tom Pearson his heirs and assigns at the Will of the Lord according to the custom of the Manor by the rents suits and services therefor due and of right accustomed and he gives to the Lord for a Fine as in the margin is admitted Tenant and his fealty is respited.

Examined by me,
Wm. English
 Steward.

Rent 2^d
 Fine 2^d

The Manor of Liddington
 with Caldecott
 in the county of Rutland

The third day of January one thousand nine hundred and seventeen.

Be it Remembered that on the day above mentioned Francis Monckton of Stratton Hall Penkridge in the county of Stafford Esquire a copyhold Tenant of the said Manor came before me Frederick Theobald Langley Deputy Steward of the said Manor and did out of court surrender out of his hands into the hand of the Lord of the said Manor by the hands and acceptance of me the said Deputy Steward by the Rod according to the custom of the said Manor to the use of Arthur Monckton

Francis Monckton Esq.
 to
 Arthur Monckton Esq.
 and Another.
 Surrender

Stamp
 10/1

3rd January 1917

of Normanstone Hall Lowestoft in the County of Suffolk Esquire and John Henry Monckton of Meriden near Coventry in the County of Warwick a Colonel retired in His Majesty's Army their heirs and assigns forever at the Will of the Lord according to the custom of the said Manor by and under the rents fines heriots suits and services due and of right accustomed for the same.

Firstly All that piece of old pasture land situate at Liddington aforesaid within the said Manor containing by admeasurement Four acres three roods ^{and thirty six} ~~seven~~ perches and formerly reputed to contain Four acres three roods seven perches bounded on the east by the boundary of the Parish of Thorpe-by-Water and land the property of Mr. J. J. Ward and on the West in part by the road from Liddington to Gretton and on the remainder of the west and on the south by land of Mr. H. Freeman and Mr. H. S. J. Bullock and on the north by land belonging to George Edward Monckton Esquire and forming the southerly portion of the field or enclosure numbered 253 on the 1902 revised edition of the Ordnance Survey and which is now in the occupation of Mr. H. H. Clark under the yearly rent of four pence As described in the admission of Francis Monckton dated fifteenth day of March one thousand eight hundred and eighty eight as all that close piece or parcel of land or ground situate lying and being at Liddington aforesaid within the said Manor containing by admeasurement Four acres three roods and seven perches bounded on the east being a very irregular boundary by the Hamlet of Thorpe-by-Water on part of the south by land late of Mary Barfoot on the West and remaining part of the south by land of Clement Pretty and the Gretton Road and on the North by freehold land awarded to William Brane then in the occupation of Hugh Clarke held by copy of Court Roll under the yearly rent of four pence and to which the said John Monckton deceased was admitted tenant at a General Court held in and for the said Manor on the twentieth day of May one thousand eight hundred and forty seven on the surrender of William Brane And secondly All that piece or parcel of old pasture land situate in what was formerly known as the Middle Field in the Parish of Liddington and extending

3rd January 1917.

as to a small portion thereof into the Parish of baldecott within the said Manor containing eight acres two roods and twenty-six perches or thereabouts and formerly reputed to contain eight acres two roods ten perches lying to the north west of the Road from baldecott to Thorpe by Water forming the South-western portion of a field or enclosure Numbered 23 on the 1902 revised edition of the Ordnance Survey now or lately in the occupation of Mr. R. J. Ward held by copy of court Roll under the yearly rents of Two shillings and two pence and one shilling and nine pence As described in the admission of Francis Monekton dated fifteenth day of March One thousand eight hundred and eighty eight as all that piece or parcel of land situate in the Middle Field in the Parish of Liddington aforesaid within the said Manor containing eight acres two roods and twelve perches bounded on the North east by freehold lands allotted to John Ougden on the Southeast by the baldecott Road on the South west by land allotted to Thomas Bryan then in the occupation of James Morris held by copy of court Roll under the yearly rents of two shillings and two pence and one shilling and nine pence and to which the said John Monekton deceased was admitted tenant at a General court held in and for the said Manor on the twentieth day of May One thousand eight hundred and fifty two on the Surrender of Hodgskin Peach and John Laxton Baines. And thirdly All that piece or parcel of land situate and being in what was formerly known as the Middle Field of baldecott in the Parish of baldecott within the said Manor containing twenty seven acres two roods thirty three perches bounded on the Northeast by the Parish boundary between baldecott and Liddington and which in the 1902 revised Edition of the Ordnance Survey is shown as N^o 127 containing one acre twenty three perches and N^o 133 containing seventeen acres three roods twenty four perches made up of pieces or parcels formerly reputed to contain fifteen acres three roods thirty four perches and one acre held by copy of court Roll (with other lands) under the several yearly rents of Two shillings Two shillings and four pence six pence and seven pence three farthings As described in the admission of Francis Monekton dated fifteenth day of March One thousand eight

3rd January 1917.

hundred and eighty eight, as all that piece or parcel of land situate and being in the Middle field in the Parish of baldecott in the County of Rutland within the said Manor containing one acre and twelve perches bounded on the Northwest by the first allotment made on the enclosure of the open and common fields of baldecott aforesaid to Mary Baxter on the North east by the Parish of Liddington on the Southeast by the Liddington Road and on the Southwest by the second allotment made to the said Mary Baxter and also All that piece or parcel of land situate and being in the Middle field of baldecott aforesaid within the said Manor containing fifteen acres three roods and thirty four perches bounded on the Northwest by the second allotment to the Marquis of Exeter on the Northeast by the Parish of Liddington on part of the South East by the first allotment made to the Vicar for Tithes on part of the South west and remaining part of the Southeast by the next described piece or parcel of land and on the remaining part of the Southwest by the first copyhold allotment awarded to John Walker and also all that piece or parcel of land in the Middle field of baldecott aforesaid within the said Manor containing one acre set out by the Commissioners of the said Inclosure in lieu of copyhold meadow and subject to mires bounded on the Northwest and Northeast by the lastly before described piece or parcel of land on the Southeast by the first allotment to John Walker then in the occupation of James Morris held by copy of Court Roll under the several yearly rents of Two shillings, Two shillings and four pence, Six pence and Seven pence three farthings, and to which the said John Monekton deceased was admitted Tenant at a General Court held in and for the said Manor on the twentieth day of May One thousand eight hundred and fifty two on the surrender of Hodgskin Peach and John Laxton Baines to all of which hereditaments the said Francis Monekton was admitted tenant at a Special Court held on the fifteenth day of March One thousand eight hundred and eighty eight, as heir at law of George Monekton deceased. — Francis Monekton. — Taken the day and year first above written by me Frederick J. Langley Deputy Steward.

Examined by me,



Steward.

12th January 1917**The Manor of Liddington**

with Caldecott

in the County of Rutland

Be it rememberedthat on the twelfth day of January one thousand nine hundred and seventeen **Alfred Hays**

Mr. Alfred Hays

to

Messrs Saml. & Ed.

S. Arnoby.

Absolute
Surrender

of Perry House West End Esher in the County of Surrey, Retired Butcher came before me Frank Edward Hodgkinson of Uppingham in the County of Rutland Deputy Steward of the Manor for this turn and purpose only of Richard Mills English Steward of the Manor out of Court and in consideration of the sum of Three thousand three hundred and thirty pounds to him paid by Samuel Arnoby and Edward Sewell Arnoby both of Uppingham in the said County of Rutland Graziers surrendered into the hands of the Lord of the Manor by the hands and acceptance of his said Deputy Steward according to the custom of the Manor All that close piece or parcel of pasture land situate lying and being in the Lordship of Liddington in the County of Rutland called Marsh Slade and Marsh Slade Meadow and formerly said to contain fifty three acres or thereabouts but by a recent survey thereof found to contain fifty five acres two roods and ten perches or thereabouts late in the tenure or occupation of Thomas Satchell then of William Thomas Hays and now of William Ryland held by copy of Court Roll of the said Manor of Liddington with Caldecott under the yearly rents of four shillings and two pence three shillings and five pence, one shilling and eleven pence, five shillings and one penny, three farthings, two shillings and three pence, One shilling, one shilling and three pence, and three shillings and eleven pence. All which said hereditaments are numbered 272 on the Ordnance Survey Map (1886 Edition) of Liddington aforesaid and contains fifty five acres three roods and twenty one perches (and to which the said Alfred Hays was admitted Tenant at a Special Court held on the fourth day of December One thousand eight hundred and eighty eight To the use of the said Samuel Arnoby and Edward Sewell Arnoby their heirs and assigns for ever as Tenants in common in equal shares at the will of the Lord according to the custom of the said Manor at and under the rents fines heriots suits and services thereof due and of right accustomed. Alfred Hays. This surrender, was

Stamp
£33.70/-

20th January 1917.

taken and accepted the day and year first above written by me
F. E. Hodgkinson Deputy Steward of the Manor for this term
and purpose only.

Examined by me,
Richard Mills
Steward.

The Manor of Liddington

with Caldecott
in the county of Rutland

The Admission of Samuel

Arnsby out of court at Stamford on the
twentieth day of January one thousand nine

hundred and seventeen Before Richard Mills English Steward
of the courts of the Most Honorable William Thomas Brownlow
Marquis of Exeter Baron of Burghley Lord of the said Manor.

Samuel Arnsby on
Surrender of Alfred
Hayr.

Surrendered

that on the twentieth day of January
one thousand nine hundred and seventeen Samuel Arnsby of
Uppingham in the county of Rutland Grazier by his Attorney Fred
Andrews came before me Richard Mills English Steward of the
courts of the said Manor and prayed to be admitted Tenant to an
undivided moiety of and in All that close of pasture land situated
in Liddington in the county of Rutland called Marsh Slade and
Marsh Slade Meadow formerly said to contain Fifty three acres or
thereabouts but by a recent admeasurement thereof found to contain
Fifty five acres two roods and ten perches or thereabouts late in the
occupation of William Thomas Hayr but now of William Ryland
held by copy of court Roll of the said Manor under the yearly rents
of four shillings and twopence, three shillings and five pence, one
shilling and eleven pence five shillings and one penny three farthings
two shillings and three pence one shilling one shilling and three
pence and three shillings and eleven pence. To which hereditaments
Alfred Hayr was admitted Tenant on the fourth day of December
one thousand eight hundred and eighty eight upon the surrender of
Eliza Barnes and another and which said hereditaments were on
the twelfth day of January one thousand nine hundred and seventeen
surrendered by the said Alfred Hayr to the use of the said Samuel

Samuel Arnsby
5. 2. 17

*certify that this Surrender
bears a Stamp of thirty three
pounds ten shillings*
Richard Mills
Steward

Re

Moi
Fin

Ch

Edm
Arns
of A

Adm

20th January 1917.

Rents
 4. 2
 3. 5
 1. 11
 5. 1 ³/₄
 2. 3
 1. 0
 1. 3
 3. 11
1. 3. 0 ³/₄

Moiety. 11. 6 ³/₄

Fine. 11. 6 ³/₄

Arnoby and Edward Seruell Arnoby their heirs and assigns as tenants in common at the Will of the Lord according to the custom of the Manor as appears by the said Surrender which has been duly entered upon the court rolls of the Manor ~~Cowfold~~ the Lord by his said Steward granted seizin by the Rod ~~Cowfold~~ an undivided moiety of the hereditaments aforesaid with the appurtenances unto the said Samuel Arnoby his heirs and assigns at the Will of the Lord according to the custom of the Manor by the rents suits and services therefor due and of right accustomed and he gives to the Lord for a Fine as in the margin is admitted Tenant and his fealty is respited

Examined by me,

Richard Mills

Steward.

The Manor of Liddington

with Caldercott

in the county of Rutland

The Admission of Edward

Seruell Arnoby out of court at Stamford on the twentieth day of January one thousand

nine hundred and seventeen Before Richard Mills English Steward of the courts of the Most Honorable William Thomas Brownlow Marquis of Exeter Baron of Burghley Lord of the said Manor.

Edward Seruell Arnoby on Surrender of Alfred Hays.

Remembered

that on the twentieth day of January one thousand nine hundred and seventeen Edward Seruell Arnoby of Uppingham in the county of Rutland Grazier by his Attorney Fred Andrews came before me Richard Mills English Steward of the courts of the said Manor and prayed to be admitted Tenant to an undivided moiety of and in All that close of pasture land situated in Liddington in the county of Rutland called Marsh Slade and Marsh Slade Meadow formerly said to contain Fifty three acres or thereabouts but by a recent admeasurement thereof found to contain Fifty five Acres two roods and ten perches or thereabouts late in the occupation of William Thomas Hays but now of William Ryland held by copy of court Roll of the said Manor under the yearly rents of Four shillings and two pence, Three shillings and five pence, One shilling and eleven pence, Five shillings and one penny three farthings, Two shillings

Admission to the Manor of Liddington 5.2.17

13th February 1917.

and three pence, One shilling, One shilling and three pence and three shillings and eleven pence. To which hereditaments Alfred Hays was admitted Tenant on the fourth day of December, One thousand eight hundred and eighty eight upon the Surrender of Eliza Barnes and another and which said hereditaments were on the twelfth day of January one thousand nine hundred and seventeen surrendered by the said Alfred Hays to the use of the said Edward Sewell Annsby and Samuel Annsby their heirs and assigns as tenants in common at the Will of the Lord according to the custom of the Manor as appears by the said Surrender which has been duly entered upon the Court Rolls of the Manor. **Common** the Lord by his said Steward granted seizin by the Rod. **Co Sio** an undivided moiety of the hereditaments aforesaid with the appurtenances unto the said Edward Sewell Annsby his heirs and assigns at the Will of the Lord according to the custom of the Manor by the Rents suits and services thereof due and of right accustomed and he gives to the Lord for a Fine as in the margin is admitted Tenant and his fealty is respited.

Testify that this Surrender bears a stamp of thirty three pence ten shillings
Sturms

<u>Rents</u>	4	2
	3	5
	1	11
	5	1 ³ / ₄
	2	3
	1	0
	1	3
	3	11
	1	3 0 ³ / ₄

Moiety 11. 6 ³/₄

Fine 11. 6 ³/₄

Examined by me,
Sturms
 Steward.

The Manor of Liddington

with baldecott

in the County of Rutland

The Admission of John Edward

Marwin out of Court in the Borough of

Stamford on the thirteenth day of February one thousand nine hundred and seventeen Before Richard Mills English Steward of the Courts of the Most Honorable William Thomas Browlow Marquis of Exeter Baron of Bughley Lord of the said Manor.

John Edward Marwin

Devisee of

Robert Clarke

Whereas Robert Clarke late of Liddington Builder by his Will dated the sixteenth day of September one thousand eight hundred and ninety five devised his real Estate at Liddington unto his Trustees Mary Clarke (his Wife) John Edward Marwin and William Clarke Upon Trust to permit his Wife to have the use and enjoyment of to

Admission to Mr. J. J. Marwin
 7.11.17

13th February 1917.

receive the rents and profits thereof during her lifetime, and from and after her decease Upon Trust for sale. And whereas at a court held in and for the Manor on the seventeenth day of November One thousand nine hundred and four the said Mary Clarke was admitted Tenant for her life of the hereditaments hereinafter described ~~Now~~ be it remembered that on the thirteenth day of February One thousand nine hundred and seventeen the said John Edward Marwin of Liddington Farmer by his Attorney Fred Andrews came before me Richard Mills English Steward of the courts of this Manor and represented that the said Mary Clarke died on the thirteenth day of June One thousand ~~one thousand~~ nine hundred and fourteen and that the said William Clarke died on the twenty fifth day of January One thousand nine hundred and four and there upon prayed to be admitted Tenant to the hereditaments and premises of which the said Robert Clarke died seized and which were so devised to him as aforesaid to wit All that Dwellinghouse with the outbuildings and appurtenances situated in the Village of Liddington formerly in the occupation of A. Webster and now of John Henry French bounded towards the East and South by the Village Street or highway from Bretton to Uppingham, towards the West by lands of William Middleton and towards the North by hereditaments of Joseph Clarke. ~~Now~~ the Lord by his said Steward granted seizin by the Rod. ~~Now~~ the hereditaments aforesaid with the appurtenances unto the said John Edward Marwin his heirs and assigns as in the said Will mentioned at the Will of the Lord according to the custom of the Manor by the rents suits and services therefor due and of right accustomed and he gives to the Lord for a Fine as in the margin is admitted Tenant and his Fealty is respited.

Rent. d
 2

Fine. d
 2

Examined by me,

Richard Mills
Steward.

28th December 1916.

The Manor of Liddington

with baldecott

in the county of Rutland

The Admission of George

Brown out of court at Stamford on the twenty eighth day of December one thousand nine hundred and sixteen Before Richard Mills English Steward of the courts of the Most Honorable William Thomas Brownlow Marquis of Exeter Baron of Burghley Lord of the said Manor

George Brown

Devisee of

Thomas Brown

Be it remembered

that on the twenty eighth day of December one thousand nine hundred and sixteen George Brown of baldecott in the county of Rutland Grazier by Frederick Andrews his Attorney came before me Richard Mills English Steward of the courts of the Manor and represented that Thomas Brown late of baldecott Grazier a copyhold or customary Tenant of the Manor died on the eleventh day of March one thousand nine hundred and six seized to him and his heirs of All that close of land containing one acre one rood and twenty perches or thereabouts being part of a close of land containing three acres two roods known as Snelstones situated at baldecott within the said Manor in a place there formerly known as the "Ashes" and bounded on the West by the baldecott, and Uppingham Road held by copy of court Roll under the yearly rent of two pence. And also all that close of land containing six acres and sixteen perches in the Middlefield in baldecott aforesaid bounded on or towards the Southeast by the Road leading to Liddington held by copy of court Roll under the yearly rent of one shilling and ten pence. And also all that close of land adjoining the last described hereditaments containing six acres three roods and thirty perches held by copy of court ^{Roll} with the hereditaments containing one rood and six perches and one rood and twenty six perches held by copy of court Roll hereinafter described under the yearly rent of two shillings and three pence, And also all that Messuage recently erected by the said George Brown upon the site of a cottages adjoining the Green in baldecott aforesaid together with the garden and Paddock thereto adjoining formerly described as two closes containing respectively one rood and six perches and one rood and twenty six perches held by copy of court Roll with the before

Adm. Co. to Mr. Oakley
22.11.17

Re
Fi

28th December 1916.

described close of land containing six acres three roods and thirty perches under the yearly rent of two shillings and three pence. And also all that cottages or tenement formerly described as a House and Bakehouse with the North east end of House adjoining situated in Baldecott aforesaid held by copy of Court Roll under the yearly rents of six pence three pence and two pence All of which before described hereditaments are in the occupation of the said George Brown, and to which the said Thomas Brown deceased was admitted Tenant at a Court held on the twenty fifth day of April one thousand eight hundred and thirty nine And it is also represented to me that the said Thomas Brown by his Will dated the twenty eighth day of April One thousand nine hundred and two and a Codicil thereto dated the second day of September one thousand nine hundred and two devised the whole of his Real Estate to the said George Brown subject to the payment of an Annuity to his (Testators) Wife (who subsequently died in his lifetime) the Probate of which Will and Codicil dated the seventeenth day of August One thousand nine hundred and six has been produced to me and entered on the Court Rolls of the Manor. Whereupon the said George Brown by his said Attorney prayed to be admitted Tenant to the hereditaments of which the said Thomas Brown died seized and so devised to him as aforesaid Copyhold the Lord by his said Steward granted seizin by the Rod. Copyhold the hereditaments aforesaid with their appurtenances unto the said George Brown his heirs and assigns at the Will of the Lord according to the custom of the Manor by the Rents suits and services therefor due and of right accustomed and he gives to the Lord for Fines as in the margin is admitted Tenant and his fealty is respited.

Examined by me,
Thomas English
 Steward.

<u>Rents.</u>	2
1..	10
2..	3
	6
	3
	2
	<u>2</u>
5.	2
<u>Fines.</u>	2
1.	10
2.	3
	6
	3
	2
	<u>2</u>
5.	2

26th March 1917

The Manor of Liddington

with baldecott

in the County of Rutland

Be it remembered

that on the twenty sixth day of March one thousand nine hundred and seventeen John

Mr John Edward Marwin

to

Mrs S. French and Mr John Henry French

Absolute Surrender

Edward Marwin of Liddington in the County of Rutland in Farmer one of the copyhold or customary Tenants of the said Manor came before Richard Mills English of Stamford in the County of Lincoln Steward of the Courts of the said Manor and in consideration of the sum of Fifty six pounds to the said John Edward Marwin paid by S. French (the Wife of John Henry French of Liddington aforesaid boachman) and the said John Henry French out of monies belonging to them on a joint account (the receipt whereof the said John Edward Marwin hereby acknowledges) the said John Edward Marwin did out of court surrender into the hands of the Lord of the said Manor by the hands and acceptance of the said Steward by the rod according to the custom of the said Manor All that dwellinghouse with the outbuildings and appurtenances situate in the Village of Liddington aforesaid formerly in the occupation of John Thomas Clarke then of A. Webster afterwards of Robert Clarke and now of the said John Henry French bounded towards the East and south by the Village Street or highway from Gretton to Uppingham towards the West by land and buildings of William Middleton and towards the North by hereditaments of Joseph Clarke to which hereditaments the said John Edward Marwin was admitted tenant on the thirteenth day of February One thousand nine hundred and seventeen as the surviving Trustee of the Will of Robert Clarke To the use of the said S. French and John Henry French their heirs and assigns forever at the Will of the Lord according to the custom of the said Manor and under and subject to the rents fines suits and services therefor due and of right accustomed but free from all incumbrances created by him. And it is certified that this transaction does not form part of a larger transaction or of a series of transactions in respect of which the amount or value or the aggregate amount or value of the consideration exceeds Five hundred pounds - J. E. Marwin Taken and accepted the day and year first above written by me -

Step 4/6

The Arthur John on Sec Mon

Ad

23rd January 1917.

Richard M. English, Steward of the said Manor, Received this 26th day of March, One thousand nine hundred and seventeen from the above named S. French and John Henry French the sum of Fifty six pounds being the consideration money above mentioned to be paid by them to me £56. J. E. Marwin Witness Richd. M. English.

Examined by me,
Richard M. English
Steward.

The Manor of Liddington

with Caldecott

in the County of Rutland

The Admission of Arthur Monckton and John Henry Monckton

out of Court at Stamford on the twenty third day

of January one thousand nine hundred and seventeen Before Richard Mills English Steward of the Courts of the Most Honorable William Thomas Brownlow Marquis of Exeter Baron of Burghley Lord of the said Manor.

Arthur Monckton &
John Henry Monckton
on Surrender of Francis
Monckton.

Be it remembered

that on the twenty third day of January one thousand nine hundred and seventeen Arthur Monckton of Normanstone Hall Lowestoft in the County of Suffolk Esquire and John Henry Monckton of Meriden in the County of Warwick a Colonel retired in His Majesty's Army by their Attorney Frederick Andrews came before Richard Mills English Steward of the Courts of the Manor and prayed to be admitted Tenants to All that piece of old pasture land situated at Liddington within the said Manor containing four acres, three roods and thirty six perches and formerly reputed to contain four acres three roods and seven perches bounded on the East by the boundary of the Parish of Thorpe by Water and land of J. F. Ward on the West in part by the Road from Liddington to Bretton and on the remainder of the West and on the South by lands of H. Freeman and H. J. Bullock and on the North by land of George Edward Monckton and forming the southerly portion of the field or enclosure N^o 253 on the 1902 revised edition of the Ordnance

Admission to the
Manor of Liddington
18.11.17

23rd January 1917.

Survey and now in the occupation of H. H. Clark. Which hereditaments were formerly described as being bounded on part of the South by land of Mary Barfoot on the West and remaining part of the South by land of Clement Pretty and the Bretton Road and on the North by freehold land awarded to Edward Crane and are held under the yearly rent of four pence. Also all that piece or parcel of old pasture land situated in what was formerly known as the Middle field in the Parish of Liddington and extending as to a small portion thereof into the Parish of Baldecott within the said Manor containing eight acres two roods and twenty six perches or thereabouts and formerly reputed to contain eight acres two roods and twelve perches lying to the Northwest of the Road from Baldecott to Thorpe by Water forming the Southwest portion of a field or enclosure No. 23 on the 1902 Revised Edition of the Ordnance Survey now in the occupation of R. J. Ward. Which hereditaments were formerly described as being bounded on the North east by Freehold lands allotted to John Ogden on the South East by the Baldecott Road on the South west by lands allotted to Thomas Bryan and are held under the yearly rents of two shillings and two pence and one shilling and nine pence. And also all that piece or parcel of land situated and being in what was formerly known as the Middle field of Baldecott within the said Manor containing nineteen acres and seven perches (in the Surrender of the same erroneously mentioned as containing twenty seven acres two roods and thirty three perches) bounded on the Northeast by the Parish boundary between Baldecott and Liddington and which in the 1902 revised Edition of the Ordnance Survey is shown as No. 127 containing One acre, and twenty three perches and No. 133 containing seventeen acres, three roods and twenty four perches made up of pieces or parcels formerly reputed to contain fifteen acres three roods and thirty four perches and one acre. Which hereditaments were formerly described as a piece of land in the Middlefield containing one acre and twelve perches bounded on the Northwest by the first allotment made on the enclosure of Baldecott to Mary Baxter on the Northeast by the Parish of Liddington on the Southeast by the Liddington Road and

This
Stamp

Rev

Five

1st

2nd

23rd January 1917

"on the Southwest by the second allotment made to the said Mary Baxter. And also a piece of land in the Middlefield containing fifteen acres three roods and thirty four perches bounded on the Northwest by the second allotment to the Marquis of Exeter on the Northeast by the Parish of Liddington on part of the South east by the first allotment to the Vicar for Tithes on part of the Southwest, and remaining part of the South East by the next described piece of land and on the remaining part of the Southwest by the first allotment to John Walker. And also a piece of land in the Middlefield containing one acre set out by the Commissioners of the said Enclosure in lieu of copyhold Meadow and subject to modus bounded on the Northeast and Northwest by the lastly described piece of land on the Southeast by the first allotment to John Walker held by copy of bowt Roll under the several yearly rents of two shillings, two shillings and four pence, six pence and seven pence three farthings." To which hereditaments hereinbefore described Francis Monckton, was admitted tenant on the fifteenth day of March one thousand eight hundred and eighty eight as heir at law of George Monckton deceased and which were by him surrendered on the third day of January one thousand nine hundred and seventeen to the use of the said Arthur Monckton and John Henry Monckton their heirs and assigns forever at the Will of the Lord according to the custom of the said Manor by and under the rents, fines, heriots, suits and services due and of right accustomed as appears by the said Surrender which has been duly entered upon the bowt Rolls of the Manor. To whom the Lord by his said Steward granted seizin by the Rod. To hold the hereditaments aforesaid with their appurtenances unto the said Arthur Monckton and John Henry Monckton their heirs and assigns at the Will of the Lord according to the custom of the Manor by the rents suits and services therefor due and of right accustomed and they give to the Lord for Fines as in the margin are admitted Tenants and their fealty is respited.

This Surrender bears a Stamp of two shillings
Rowland
 Steward

<u>Rents</u>	4
2 "	2
1 "	9
2 "	0
2 "	4
	6
	7 ³ / ₄
	<hr/>
	9 " 8 ³ / ₄

<u>Fines</u>	
1 st Life	9 " 8 ³ / ₄
2 nd do	4 " 10 ³ / ₈

Examined by me,

Rowland

Steward.

The Most Honorable
The Marquis of Exeter
to
Mr Tom Pearson

Deed of
Enfranchisement

Step 6.

This Indenture made the ~~twentieth~~ ^{twentieth} day of May One thousand nine hundred and seventeen ~~Between~~ ^{Between} The Most Honorable William Thomas Brownlow Marquis of Exeter Baron of Burghley hereinafter called "the Marquis" of the one part and Tom Pearson of the Feast Ground barbrook Near Sheffield in the county of York Butcher of the other part Whereas the Marquis is seized in fee simple of the Manor of Liddington with Caldercott in the county of Rutland. And whereas on the twenty eighth day of December One thousand nine hundred and sixteen the said Tom Pearson was admitted tenant to the hereditaments hereinafter described under a Deed of appointment from Harold Bryan and Thomas Henry Wilson. And whereas the Marquis has agreed with the said Tom Pearson for the Enfranchisement of the said hereditaments for the sum of Nineteen shillings.

Now this Indenture witnesseth that in consideration of Nineteen shillings to the Marquis paid by the said Tom Pearson on or before the execution of these presents (the receipt whereof the Marquis doth hereby acknowledge) the Marquis as Beneficial owner hereby Enfranchises and conveys to the said Tom Pearson. All that cottage or tenement (formerly called the half part of a cottage or tenement) with the yard garden and appurtenances thereto belonging situated in Liddington within the said Manor late in the occupation of the said Tom Pearson and now of Branston. Together with the appurtenances excepting the rights reserved by the copyhold Act 1894 section 23. To hold the same as freehold free and discharged from all rents, fines, suits and services and other incidents of copyhold tenure except as aforesaid Unto and to the use of the said Tom Pearson in fee simple. And it is certified that the transaction hereby effected does not form part of a larger transaction or of a series of transactions in respect of which the amount or value or the aggregate amount or value of the consideration exceeds Five hundred pounds. In witness whereof the said parties to these presents have hereunto set their hands and seals the day and year first above written @ Exeter by his Attorney Fred. J. Peregrine Birch Signed sealed and delivered by the above named William Thomas Brownlow Marquis of Exeter in the presence of E. Foster, Spinster Marsbrook 96 60. May. 1871
Examined by me, *Chas. English* Steward.

The
Sarah
John
on su
Eduwa

This
stamp
six pen

22nd June 1917**The Manor of Liddington**

with Caldecott

in the County of Rutland

The Admission of Sarah French
and John Henry French out of court
at Stamford on the twenty second day of June

One thousand nine hundred and seventeen Before Richard Mills
English Steward of the courts of the Most Honorable William Thomas
Brounlow Marquis of Exeter Baron of Burghley Lord of the said
Manor.

Sarah French and
John Henry French
on surrender of John
Edward Marwin.

Be it remembered that on the twenty second day of June one
thousand nine hundred and seventeen Sarah French the wife of John
Henry French of Liddington in the County of Rutland co. achuan
and the said John Henry French by Harry Naylor their Attorney
came before Richard Mills English Steward of the courts of the Manor
and prayed to be admitted Tenants to All that Dwellinghouse with
the outbuildings and appurtenances situated in Liddington afore-
said formerly in the occupation of Robert Clarke and now of the said
John Henry French bounded towards the East and South by the Village
Street or highway from Bretton to Uppingham towards the West by land
and buildings of William Middleton and towards the North by
hereditaments of Joseph Clarke. To which hereditaments John Edward
Marwin was admitted tenant on thirteenth day of February One
thousand nine hundred and seventeen as the surviving Trustee under
the Will of Robert Clarke deceased and which were by him surrendered
on the twenty sixth day of March One thousand nine hundred and
seventeen to the use of the said Sarah French and John Henry French
their heirs and assigns at the Will of the Lord according to the custom
of the said Manor and under and subject to the rents fines suits and
services therefor due and of right accustomed as appears by the said
surrender which has been duly entered upon the Court Rolls of the said
Manor **To WIT** the Lord by his said Steward granted seizin by
the Rod **To HOLD** the hereditaments aforesaid with their appurtenances
unto the said Sarah French and John Henry French their heirs and
assigns at the Will of the Lord according to the custom of the Manor
by the rents suits and services therefor due and of right accustomed
and they give to the Lord for Fines as in the margin are admitted

This surrender bears a
stamp of seven shillings and
six pence Adm. Steward

30th June 1917.

Rent	2 ^d
Fines	
1 st life	2 ^d
2 nd life	1
	<u>3^d</u>

Tenants and their fealty is respited.
 Examined by me,
 Crommleyfield
 Steward.

The Manor of Liddington
 with baldecott
 in the county of Rutland

The Admission of John Robert

Pretty out of court at Stamford on the thirtieth day of June One thousand nine hundred and seventeen Before Richard Mills English Steward of the courts of the Most Honorable William Thomas Brownlow Marquis of Exeter Baron of Bughley Lord of the said Manor.

John Robert Pretty
 on surrender of Jane
 Pretty, William Pretty
 and Thomas Nicholls
 Pretty.

Be it remembered that on the thirtieth day of June One thousand nine hundred and seventeen John Robert Pretty of Burgess Hill in the county of Sussex Coachman by Thomas Nichols Pretty his Attorney came before Richard Mills English Steward of the courts of the Manor and prayed to be admitted Tenant to All that cottage house with the Barrow Orchard and appurtenances thereto belonging situated at Liddington aforesaid late in the occupation of Francis Kelham Wright and now of John Hallender to which hereditaments Jane Pretty William Pretty and Thomas Nichols Pretty were admitted tenants on the twenty seventh day of May One thousand nine hundred, and seven, as devisees of Thomas Pretty deceased under the yearly rent of One shilling and threepence and which were ~~subsequently~~ upon the ~~20th~~ ^{20th} day ^{of June 1907} surrendered by them to the use of the said John Robert Pretty his heirs and assigns at the Will of the Lord according to the custom of the Manor as appears by the said surrender which has been duly entered upon the Court Rolls of this Manor. **To Whom** the Lord by his said Steward granted seizin by the Rod **To Hold** the hereditaments aforesaid with their appurtenances unto the said John Robert Pretty his heirs and assigns at the Will of the Lord according to the custom of the Manor by the rents suits and services therefor due and of right accustomed and he gives to

Verify that this surrender
 bears a ten shilling stamp
 Crommleyfield
 Steward.

R
 7
 Inrol
 Sarat
 Vis
 June

Rent 1. 3

Fine 1. 3

The Lord for a Fine as in the margin is admitted Tenant and his fealty is respited.

Examined by me,

Richard Gledhill

Steward.

Involvement of Will of
Sarah Ann Tyler.

Dec 21. 17
June 27. 17

This is the Last Will and Testament of me Sarah Ann Tyler of Liddington in the county of Rutland Widow I appoint my brothers Arthur Edward Manton and John Tirrell Manton (who and the survivor of them or other the Trustee or Trustees for the time being of this my Will are hereinafter called "my Trustees") to be the Executors and Trustees of this my Will I give and bequeath all my plate linen glass books pictures furniture and other household effects together with my book debts stock in trade of a Grocer and trade utensils to my Niece Elsie Ann Manton absolutely I give to each of my Nieces who may be living at the time of my decease a Legacy or sum of Five pounds for their own absolute use and benefit I devise all that my close of freehold land known as "the Top Town Close" situate at Liddington aforesaid to the said Arthur Edward Manton for his own absolute use and benefit And I bequeath the rest residue and remainder of my personal Estate to which I shall be entitled at my decease or to which I shall have any general power of appointment by Will to the said Arthur Edward Manton and John Tirrell Manton I devise all the copyhold real estate wheresoever situate and to which I shall be entitled at my decease to the use of such person or persons and in such manner as my trustees shall within twenty-one years after my decease by any deed or deeds for the purpose of carrying into effect any sale made under the trust in that behalf hereinafter declared appoint and in default of and until such appointment I devise my said copyhold real estate unto and to the use of the said Arthur Edward Manton in trust for my trustees and to be surrendered and disposed of as they shall direct. And I direct my trustees to sell my said copyhold real estate and to sell call in and convert into money such part of my said residuary personal Estate as shall not consist of money And I declare

that my trustees shall stand possessed of the moneys to arise from the sale calling in and conversion of my said copyhold and residuary personal estate and of the moneys of which I shall stand possessed at my decease Upon trust to pay thereout my funeral and testamentary expenses and debts and the legacies hereinbefore bequeathed And upon trust to divide the remainder of such moneys equally between all my brothers and sisters and Sophia Susannah Woodward and Emily Elizabeth Manton (Widow of my brother Richard Samuel Manton) the share of the said Arthur Edward Manton and John Tirrell Manton to be for their own absolute use and benefit. Provided always that if any of my brothers or sisters shall die in my lifetime leaving a child or children who shall survive me and being a son or sons shall attain the age of twentyone years or being a daughter or daughters shall attain that age or marry under that age then and in every such case the last mentioned child or children shall take (and if more than one equally between them) the share which his or their parent would have taken of and in the remainder of the said Money if such parent had survived me In witness whereof I have hereunto set my hand this twentyfourth day of March One thousand nine hundred and ten S. A. Tyler signed by the said Sarah Ann Tyler the Testatrix as her last Will in the joint presence of herself and us who at her request and in such joint presence have hereunto subscribed our names as Witnesses - Fredk. Oakley, Solr. Uppingham, John Clark Lyddington Blacksmith.

Examined by me,

Maudyell
Steward

John Kirkbride

to

F. E. Hodgkinson

Power of Attorney

To all to whom to whom these presents shall come,

I John Kirkbride of Shingleton Michigan in the United States of America Railway Foreman send greeting.

Whereas I am residing beyond the seas and am desirous of authorising Frank Edward Hodgkinson of Uppingham in the

I certify that this deed
bears a stamp of ten shillings
Oswinleyville
Steward

County of Rutland Solicitor to sell and dispose of all or any of my freehold and copyhold messuages lands tenements and hereditaments situate in the Parishes of Uppingham aforesaid Liddington in the said County of Rutland Newborough in the County of Northampton the copyhold portions of the said hereditaments being held of the respective Manors of Preston with Uppingham in the said County of Rutland Barnack with Pilsgate and Southorp in the said County of Northampton Liddington with Caldecott in the said County of Rutland and the Rectory Manor of Uppingham in the said County of Rutland and to which said copyhold hereditaments I was respectively admitted tenant on the fourth day of October One thousand nine hundred and sixteen the eleventh day of October One thousand nine hundred and sixteen, the nineteenth day of September One thousand nine hundred and sixteen and the twentieth day of October One thousand nine hundred and sixteen.

Now know ye that I the said John Kirkbride hereby irrevocably appoint the said Frank Edward Hodgkinson to be my lawful attorney for one year from the date hereof for me and in my name, and for my use to perform the following acts: —



1. To sell and dispose of all or any of my said hereditaments and premises with the appurtenances either by private contract or by Public auction and either together or in separate parcels or lots for such price as to him shall seem reasonable and under such contracts and conditions of sale as he may deem necessary.
2. Upon the receipt of the consideration or purchase money for the same or any part thereof to give a good receipt therefor which receipt shall exonerate the person paying such money from seeing to the application thereof or being responsible for the loss or misapplication thereof.
3. To sign and seal and as my act and deed deliver any deed or instrument in writing and to pass Surrenders of the said copyhold hereditaments in the said several Manors and to do every other thing whatsoever which may be necessary or proper for carrying any agreement for the purchase into complete effect and execution in such manner that all my estate right title and interest in or to the said freehold and copyhold hereditaments and premises with the appurtenances may be effectually and absolutely conveyed surrendered and assured unto

7th July 1917.

and to the use of the purchaser or respective purchasers thereof his
and their heirs and assigns forever or unto such other person
or persons and for such estate or estates therein and in such
manner and form as he or they shall direct or appoint.

And I the said John Kirkbride hereby declare that all and
every the receipts deeds surrenders matters and things which
shall be by him my said Attorney given made executed or done
for the aforesaid purposes shall be as good valid and effectual to
all intents and purposes whatsoever as if the same had been
signed sealed and delivered given or made or done by me in
my own proper person.

And I hereby undertake at all times to ratify whatsoever
my said Attorney shall lawfully do or cause to be done in or concerning
the premises by virtue of these presents.

In witness whereof I the said John Kirkbride have hereunto
set my hand and Seal this twenty fourth day of February One
thousand nine hundred and seventeen - John Kirkbride. 
Signed sealed and delivered by the said John Kirkbride in the
presence of Virgil J. Hixson  Notary Public - My Commission
Expires May 11, 1920.

Examined by me,

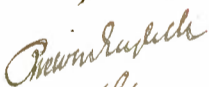
Steward.

Messrs A. E. Manton
and J. T. Manton

to

Mr. G. A. Cox

Bargain and Sale.

This Indenture made the seventh day of July One thousand
nine hundred and seventeen Between Arthur Edward
Manton of Liddington in the County of Rutland Grazier and
John Tirrell Manton of Seaton in the said County of Rutland
Carpenter (hereinafter called "the Vendors") of the one part, and
Christopher George Albert Cox of Stoke Dry in the said County
of Rutland Grazier (hereinafter called "the Purchaser") of the other part
Whereas at about held for the Manor of Liddington with Caldercott
in the said County of Rutland on the seventeenth day of November
One thousand nine hundred and four Arthur Tyler of Liddington
aforesaid Painter and Sarah Ann Tyler his Wife were duly admitted
joint tenants of the hereditaments hereinafter described subject to the

7th July 1917.

rents, fines suits and services therefor due and of right accustomed on the surrender of Henry William Stevenson John Price, and Clement John Lawrence. And whereas the said Arthur Tyler died on the thirteenth day of December One thousand nine hundred and four leaving his Wife the said Sarah Ann Tyler seized in customary fee simple of the said hereditaments by right of survivorship. And whereas the said Sarah Ann Tyler being seized as aforesaid duly made her Will dated the twenty fourth day of March One thousand nine hundred and ten and after appointing the Vendors the Executors and Trustees thereof and after certain specific bequests and devises of her freehold real Estate Testatrix devised All the copyhold real estate wheresoever situate and to which she was entitled at her decease to the use of such person or persons and in such manner as her Trustees should within twenty one years after her decease by any deed or deeds for the purpose of carrying into effect any sale made under the trusts in that behalf thereafter declared appoint. And she directed her trustees to sell her said copyhold real estate and to stand possessed of the moneys to arise from the sale thereof upon trust as therein mentioned. And whereas the testatrix died on the twenty first day of January One thousand nine hundred and seventeen without having altered or revoked her said Will and the same was proved in the Leicester District Probate Registry on the second day of July One thousand nine hundred and seventeen by both the Executors therein named. And whereas in exercise of the trust for that purpose contained in the said Will the Vendors have agreed to sell the said hereditaments to the Purchaser at the price of One hundred and thirty pounds. ~~Now~~ this Indenture witnesseth that in consideration of the sum of One hundred and thirty pounds to the Vendors paid by the Purchaser on or before the execution of these presents (the receipt whereof the Vendors do hereby acknowledge) The Vendors as Trustees in exercise of the power given to them by the said Will of the said Sarah Ann Tyler deceased as aforesaid and of all other powers (if any) then hereunto enabling do hereby bargain sell and appoint unto the said Purchaser All that allotment piece or parcel of land formerly described as containing two acres and thirty three perches but by recent

14th July 1917.

Government survey found to contain Two acres one rood and eleven perches or thereabouts situate in Lyddington aforesaid within and holden of the said Manor of Lyddington, with baldecott bounded on the North east by a private road on the Southeast by allotments to Hugh Clark and John Nutt respectively formerly belonging to Mary Ann Dawson and Hepsibah Manton on the Southwest by an allotment to the Marquis of Exeter and on the Northwest by an allotment to Joseph Clarke and now of the Representatives of the late William Marchant. To hold the same unto and to the use of the Purchaser in customary fee simple according to the custom of the said Manor of Lyddington, with baldecott and by and under the rents suits and services therefor due and of right accustomed. And it is hereby declared that the transaction hereby effected does not form part of a larger transaction or of a series of transactions in respect of which the amount or value or the aggregate amount or value of the consideration exceeds Five hundred pounds. In witness whereof the said parties to these presents have hereunto set their hands and seals the day and year first above written - Arthur E. Manton & John J. Manton & signed sealed and delivered by the above named Arthur Edward Manton in the presence of Fredk. Oakley, Sole, Uppingham. & signed sealed and delivered by the above named John Tirrell Manton in the presence of Robert Browden Seaton Uppingham Farmer.

Examined by me,

Thos. Russell
Steward.

The Manor of Calderoff

with Lyddington

in the County of Rutland

Be it remembered that on the fourteenth day of July One thousand nine hundred, and seventeen, John Kirkbride of Shingleton Michigan

Mr John Kirkbride
to

Mr Alfred Jos. Manton

Absolute Surrender

in the United States of America Railway Foreman (a copyholder or customary tenant of the said Manor) by his Attorney Frank Edward Hodgkinson of Uppingham in the County of Rutland Solicitor acting under a Power of Attorney (dated the twenty fourth day of February

Alfred Jos. Manton
2/16

14th July 1917.

one thousand nine hundred and seventeen in consideration of the
 sum of seventy three pounds to him paid by Alfred Joseph
 Manton of Liddington in the said County of Rutland Carpenter
 at or before the passing of this Surrender (the receipt whereof is
 hereby acknowledged) and in pursuance of a covenant contained
 in an Indenture bearing even date herewith and made between
 the said John Kirkbride of the first part Elizabeth James Kirkbride
 of 4 Trevelyan Road Weston-Super-Mare in the County of
 Somerset Widow of the second part and the said Alfred Joseph
 Manton of the third part. Did out of Court surrender by the Rod
 into the hands of the Lord of the said Manor by the hands and
 acceptance of Richard Mills English Gentleman Steward of the
 said Manor according to the custom thereof. All that messuage
 or tenement with the Homestead yard and garden thereto adjoining
 situated at Liddington bounded on or towards the South by property
 formerly of Edward Phillip Mouchton on or towards the North by
 property of George Morris on or towards the west by property formerly
 of Thomas Pretty and now of Pretty and on or towards the East
 by the Village Street which hereditaments are now in the occupation
 of George Brewster held by copy of Court Roll of the said Manor under the
 yearly rent of one penny And to which the said John Kirkbride was
 admitted tenant out of Court on the nineteenth day of September one
 thousand nine hundred and sixteen as Devises of John Jeyes Kirkbride
 Together with all ways rights easements advantages and appurtenances
 to the said copyhold premises belonging or appertaining. And all the
 estate right title interest claim and demand of him the said John
 Kirkbride in to and over the said copyhold premises and every
 part thereof To the use of the said Alfred Joseph Manton his heirs
 and assigns for ever at the Will of the Lord according to the custom
 of the said Manor 4 John Kirkbride by Frank Edward Hodgkinson
 his Attorney 4 Taken and accepted the day and year first above
 written By and Before me - Richd. M. English - Steward. 4
 I hereby certify that the transactions hereby effected does not form
 part of a larger transaction or of a series of transactions in respect
 of which the amount or value of the aggregate amount or value
 of the consideration exceeds five hundred pounds 4 John

14th July 1917.

Kirkbride by Frank Edward Hodgkinson his Attorney
Examined by me,
Richard Mills
Steward.

The Manor of Caldecott

with Liddington

in the County of Rutland

Be it remembered that on the fourteenth

day of July One thousand nine hundred and
seventeen John Kirkbride of Shingleton

Mr. John Kirkbride
to

Mr. John G. Perkins

Absolute Surrender

Michigan in the United States of America Railway Foreman (a
copyhold or customary tenant of the said Manor) by his Attorney
Frank Edward Hodgkinson of Uppingham in the County of
Rutland Solicitor acting under a Power of Attorney dated the
twentyfourth day of February one thousand nine hundred and
seventeen in consideration of the sum of Sixty pounds to him
paid by John Green Perkins of Uppingham in the said County
of Rutland Draper at or before the time of passing this Surrender (the
receipt whereof is hereby acknowledged) and in pursuance of a
covenant contained in an Indenture bearing even date herewith
and made between the said John Kirkbride of the first part
Elizabeth Pares Kirkbride of 4 Trevelyan Road Weston-super-
Mare in the County of Somerset Widow of the second part and
the said John Green Perkins of the third part Did out of Court Surrender
by the Rod into the hands of the Lord of the said Manor by the
hands and acceptance of Richard Mills English Gentleman Steward
of the said Manor according to the custom thereof. All that
messuage or cottage with the garden (formerly described as a
half cottage) situated at Liddington formerly in the occupation
of Thomas Muggleton then of Arthur Brown and now of the
said John Green Perkins held under the yearly rent of four pence
And to which the said John Kirkbride was admitted tenant out of
Court on the nineteenth day of September one thousand nine hundred
and sixteen as Demisee of John Jeyes Kirkbride. Together with all
ways rights easements advantages and appurtenances to the said
copyhold premises belonging or appertaining. And all the Estate
right, title interest claim and demand of him the said John

Aty
76

Ch

John
on S
Kirk

Ad
76

31st July 1917

Kirkbride in to and over the said copyhold premises and every part thereof. To the Use of the said John Green Perkins his heirs and assigns for ever at the Will of the Lord according to the custom of the said Manor - John Kirkbride by Frank Edward Hodgkinson his Attorney. Taken and accepted the day and year first above written By and Before me Richd. M. English, Steward. - I hereby certify that the transaction hereby effected does not form part of a larger transaction or of a series of transactions in respect of which the amount or value or the aggregate amount or value of the consideration exceeds Five hundred pounds. - John Kirkbride by Frank Edward Hodgkinson his Attorney

Examined by me,
Richard M. English
Steward.

The Manor of Liddington

with Calderott
in the County of Rutland

The Admission of John Green Perkins

out of Court at Stamford on the thirty first day of July One thousand nine hundred and seventeen Before Richard Mills English Steward of the Courts of the Most Honorable William Thomas Brownlow Marquis of Exeter Baron of Burghley Lord of the said Manor.

John Green Perkins
on Surrender of John
Kirkbride.

Be it remembered

that on the thirty first day of July one thousand nine hundred and seventeen John Green Perkins of Uppingham in the County of Rutland Draper by Fred Andrews his Attorney came before Richard Mills English Steward of the Courts of the said Manor and prayed to be admitted Tenant to All that messuage or cottage with the Garden (formerly described as a half cottage) situated at Liddington formerly in the occupation of Arthur Brown and now of the said John Green Perkins, held under the yearly rent of four pence. To which hereditaments John Kirkbride was admitted Tenant on the nineteenth day of September One thousand nine hundred and sixteen as Devisee of John Jeyes Kirkbride deceased and which were by him surrendered on the fourteenth day of July to the use of the said John Green

Admission Co to
Fred Andrews
3.8.17

25th August 1917

*certificat que dit surrender
a stamp of some shilling
difference*
Richard Mills
Steward

Perkins his heirs and assigns at the Will of the Lord according to the custom of the Manor as appears by the said Surrender which has been duly entered upon the Court Rolls of this Manor. **Copyhold** the Lord by his said Steward granted seizin by the Rod. **Copyhold** the hereditaments aforesaid with the appurtenances unto the said John Green Perkins his heirs and assigns at the Will of the Lord according to the custom of the Manor by the rents suits and services therefor due and of right accustomed and he gives to the Lord for a Fine as in the margin is admitted Tenant and his fealty is respited.

Rent 4^d
Fine 4^d

Examined by me,
Richard Mills
Steward.

The Manor of Liddington
with Caldercott
in the County of Rutland

It is remembered that on the twenty fifth day of August One thousand nine hundred and seventeen, Alice

Mrs. Alice E. Broadway
to
Mrs. Lillian A. Priestman
Surrender.

Elizabeth Broadway the wife of Charles Peter Broadway of Uppingham in the County of Rutland Ironmonger a Copyholder or customary Tenant of the said Manor in consideration of the sum of Four hundred pounds to her paid by Lillian Annie Priestman the Wife of Thomas James Priestman of the City of Birmingham Metal Refiner out of her separate estate at or before the passing of this Surrender (the receipt whereof is hereby acknowledged) and in pursuance of the Covenant contained in an Indenture dated the twenty fifth day of August One thousand nine hundred and seventeen and made between the said Alice Elizabeth Broadway of the one part and the said Lillian Annie Priestman of the other part. Did out of Court surrender by the Rod into the hands of the Lord of the said Manor by the hands and acceptance of Richard Mills English Steward of the said Manor and according to the custom thereof. All that messuage or tenement with the outbuildings, yard garden and appurtenances thereto belonging situate, in the Village of Liddington in the County of Rutland containing

Dep. 4/2

The
Lillian
or
Alice E

12th September 1917.

together three roods and five perches formerly in the occupation of William Green afterwards of Jane Colwell and now of John Kirkham and which said hereditaments are bounded on the West by the Road to Bretton, on the South by the Road to Thorpe by Water and on the North by "Lord Roberts Inn" To the use of the said Lillian Annie Priestman and her heirs as her separate estate at the Will of the Lord according to the customs of the said Manor at and under the rents fines suits and services therefor due and of right accustomed. And it is hereby certified that the transaction hereby effected does not form part of a larger transaction or of a series of transactions in respect of which the amount or value or the aggregate amount or value of the consideration exceeds Five hundred pounds - Alice Elizabeth Broadway Taken the day and year first above written by me - Richd. M. English, Steward.

Examined by me,
Richard Mills
Steward.

The Manor of Liddington

with Baldecott
in the County of Rutland

The Admission of Lillian Annie

Priestman out of Court at Stamford on the twelfth day of September one thousand nine hundred and seventeen Before Richard Mills English Steward of the Courts of the Most Honorable William Thomas Brownlow Marquis of Exeter Baron of Burghley Lord of the said Manor

Lillian Annie Priestman
on Surrender of
Alice Elizabeth Broadway

Be it remembered

that on the twelfth day of September one thousand nine hundred and seventeen Lillian Annie Priestman the Wife of Thomas James Priestman of Trafalgar Road in the City of Birmingham Metal Refiner by Fred Andrews her Attorney came before Richard Mills English Steward of the Courts of the said Manor and prayed to be admitted Tenant to All that messuage or tenement with the outbuildings yard garden and appurtenances thereto belonging situate in the Village of Liddington in the County of Rutland containing together three

Admission to
Possession of
the Manor

26th September 1917.

roods and five perches formerly in the occupation of William Green afterwards of Jane Colwell and now of John Kirkham bounded on the West by the Road to Gretton on the South by the Road to Thorpe by Water and on the North by "Lord Roberts" Inn. To which hereditaments Alice Elizabeth Broadway was admitted Tenant on the thirteenth day of December, one thousand nine hundred and sixteen upon the surrender of Elizabeth Green under the yearly rent of One shilling and which were surrendered by the said Alice Elizabeth Broadway on the twenty fifth day of August one thousand nine hundred and seventeen to the use of the said Lillian Annie Priestman and her heirs as her separate Estate at the Will of the Lord according to the custom of the Manor as appears by the said Surrender which has been duly entered upon the Court Rolls of this Manor. **To whom** the Lord by his said Steward granted seizin by the Rod **To hold** the hereditaments aforesaid with the appurtenances unto the said Lillian Annie Priestman and her heirs as her separate Estate at the Will of the Lord according to the custom of the Manor by the rents suits and services therefor due and of right accustomed and she gives to the Lord for a Fine as in the margin is admitted Tenant and her fealty is respited.

I certify that this Surrender
bears a Stamp of Impounds
Owen Ashwell
Steward

Rent 1 - 0
Fine 1 - 0

Examined by me,
Owen Ashwell
Steward.

The Manor of Liddington
with baldecott
in the County of Rutland

The Admission of Reginald Cecil Lane Mould out of Court at Stamford on the twenty sixth day of September one thousand nine hundred and seventeen Before Richard Mills English Steward of the Courts of the Most Honorable William Thomas Browne Marquis of Exeter Baron of Burghley Lord of the said Manor.

Rent
Fine

Reginald Cecil Lane Mould, Devisee of William Mould deceased.

He is remembered that on the twenty sixth day of September one thousand nine hundred and seventeen Reginald Cecil Lane Mould of Great Easton in the County of Leicester by Charles Brown Mould his Attorney came before me Richard Mills English Steward of the Courts

Admission to the Court
by post 6/11/17

26th September 1917.

of this Manor and represented that William Mould late of Great Easton aforesaid Grazier died on the fifteenth day of September One thousand nine hundred ~~hundred~~ seized of divers hereditaments holden of this Manor and by his Will dated the eleventh day of March One thousand eight hundred and ninety nine which has been duly enrolled on the Court Rolls of this Manor devised as follows. "I devise (inter alia) all that copyhold cottage with the appurtenances thereto belonging situate in the Parish of Baldecott aforesaid formerly in the occupation of Sarah Chambers and Adam Smith and now in the occupation of Helham Wright. And also a close of land situate in the Parish of Baldecott aforesaid called "Tit blode" containing about five acres (more or less) now in my occupation unto and to the use of my youngest son Reginald Cecil Lane Mould and his heirs" To which hereditaments firstly described now in the occupation of Richard Manton the said William Mould deceased was admitted tenant on the third day of March, One thousand eight hundred and ninety one under the yearly rent of sixpence upon the surrender of Arthur Samuel Stokes and others and to the hereditaments secondly described now in the occupation of George Cakin the said William Mould deceased was admitted Tenant on the twenty fourth day of March One thousand eight hundred and ninety three under the yearly rent of One shilling and tenpence upon the surrender of Rose Mary Bouskell Siow on the day first above mentioned the said Reginald Cecil Lane Mould by his said Attorney prayed to be admitted Tenant to the hereditaments so devised to him as aforesaid To whom the Lord by his said Steward granted seizin by the Rod. To hold the hereditaments aforesaid with the appurtenances unto the said Reginald Cecil Lane Mould and his heirs at the Will of the Lord according to the custom of the Manor by the rents suits and services therefor due and of right accustomed and he gives to the Lord for Fines as in the margin is admitted Tenant and his fealty is respited

Examined by me,

Rowmyns
Steward.

<u>Rents.</u>	6
1 "	10
2 "	4
<u>Fines</u>	6
1 "	10
2 "	4

3rd October 1917.

The Manor of Liddington

with baldecott

in the county of Rutland

The Admission of Alfred

Joseph Manton out of court at Stamford on the third day of

October one thousand nine hundred and seventeen Before Richard Mills English, Steward of the courts of the Most Honorable William Thomas Brownlow Marquis of Exeter Baron of Burghley Lord of the said Manor.

Alfred Joseph Manton
on Surrender of
John Kirkbride

Be it remembered

that on the third day of October one thousand nine hundred and seventeen Alfred Joseph Manton of Liddington in the county of Rutland carpenter came before Richard Mills English Steward of the courts of the said Manor and prayed to be admitted Tenant to All that messuage or tenement with the Homestead yard and garden thereto adjoining situated at Liddington bounded on the South by property of Edward Philip Mouchton on the North by property of George Morris on the west by property of Miss Pretty and Mrs. Brown and on the East by the Village Street as now in the occupation of George Brewster To which hereditaments John Kirkbride was admitted ^{Tenant} on the nineteenth day of September one thousand nine hundred and sixteen as devisee of John James Kirkbride deceased under the yearly rent of one penny and which were surrendered by the said John Kirkbride on the fourteenth day of July one thousand nine hundred and seventeen to the use of the said Alfred Joseph Manton his heirs and assigns at the Will of the Lord according to the custom of the said Manor as appears by the said Surrender which has been duly entered on the Court Rolls of this Manor **Common** the Lord by his said Steward granted seizure by the Rod **Common** the hereditaments aforesaid with the appurtenances unto the said Alfred Joseph Manton his heirs and assigns at the Will of the Lord according to the custom of the Manor by the rents suits and services therefor due and of right accustomed and he gives to the Lord for a fine as in the margin is admitted Tenant and his fealty is respited.

Adm. Co. to Tenant
5.11.17

This Surrender bears a stamp
of one shilling six pence
Bownbyfield
Steward

Rent 1^d
Fine 1^d

Examined by me,

Richard Mills English

Steward.

29th October 1917

The Most Honble.

The Marquis of Exeter

to

Mr Alfred J. Manton

Deed of
EnfranchisementThis Indenture

made the twenty ninth day of October One thousand nine hundred and seventeen Between The Most Honorable William Thomas Brownlow Marquis of Exeter Baron of Burghley (hereinafter called "The Marquis") of the one part and Alfred Joseph Manton of Liddington in the county of Rutland carpenter of the other part. Whereas the Marquis is seized in fee simple of the Manor of Liddington with baldecott in the county of Rutland. And whereas on the third day of October One thousand nine hundred and seventeen the said Alfred Joseph Manton was admitted tenant under the yearly rent of one penny to the hereditaments hereinafter described upon the surrender of John Kirkbride. And whereas the Marquis has agreed with the said Alfred Joseph Manton for the enfranchisement of the said hereditaments for the sum of One pound two shillings and sixpence. Now this Indenture witnesseth that in consideration of One pound two shillings and sixpence to the Marquis paid by the said Alfred Joseph Manton on or before the execution of these presents (the receipt whereof the Marquis doth hereby acknowledge) the Marquis as beneficial owner hereby enfranchises and conveys to the said Alfred Joseph Manton All that messuage or tenement with the homestead yard and garden thereto adjoining situated at Liddington bounded on the South by property of Edward Philip Monckton on the North by property of George Morris on the West by property of Miss Pretty and Mrs. Brown and on the East by the Village Street as now in the occupation of George Brewster. Together with the appurtenances excepting the rights reserved by the copyhold Act 1894 section 23. To hold the same as Freehold free and discharged from all rents Fines suits and services and other incidents of copyhold tenure except as aforesaid. Unto and to the use of the said Alfred Joseph Manton in fee simple. And it is certified that the transaction hereby effected does not form part of a larger transaction or of a series of transactions in respect of which the amount or value or the aggregate amount or value of the consideration exceeds Five hundred pounds. In witness whereof the said parties to these presents have hereunto set their hands and seals the day and year first above written Exeter (Ed) by his Attorney Fred J. Peregrine Birch - Signed sealed

29
65Deed to Manton
29.10.17

and delivered by the above named William Thomas Brownlow
Marquis of Exeter in the presence of James Murray, Gardener
Marshbrook Crossmolinea b^o Mayo.

Examined by me,

Richard Ingham
Steward.

This Indenture made the fourteenth day of December
One thousand nine hundred and seventeen **Between** The
Most Honorable William Thomas Brownlow Marquis
of Exeter, Baron of Burghley (hereinafter called 'the Marquis')
of the one part and Francis Monckton of Sketton Pentridge
in the County of Stafford Esquire of the other part **Whereas**
the Marquess is seized in fee simple of the Manor of Liddington
with Caldecott in the County of Rutland **And** whereas at
a Court held on fifteenth March One thousand eight hundred
and eighty eight the said Francis Monckton was admitted
Tenant in customary fee of the hereditaments described in
the Schedule hereto as Customary Heir of George Monckton deceased
under several yearly rents amounting in the whole to Six
pounds nine shillings and one penny halfpenny **And**
whereas the Marquess has agreed with the said Francis
Monckton for the enfranchisement of the said hereditaments for
the sum of Four hundred and twenty four pounds sixteen
shillings **Now** this Indenture **witnesseth** that in
consideration of Four hundred and twenty four pounds
sixteen shillings to the Marquess paid by the said Francis
Monckton on or before the execution of these presents (the receipt
whereof the Marquess hereby acknowledges) The Marquess
as Beneficial Owner hereby enfranchised and conveyed to the
said Francis Monckton **All** the hereditaments and premises
described in the Schedule hereunder written Together with the
appurtenances except the rights reserved by the Copyhold Act 1894
Section 23 **To hold** the same as freehold free and discharged from
all Rents Fines suits and services and other incidents of Copyhold

Stamp
£2 5/-

Just Received of
8.12.17

tenure except as aforesaid Unto and to the Use of the said Francis Monckton in fee simple And the Marquess hereby acknowledges the right of the said Francis Monckton to production of the Court Rolls as far as they relate to the said hereditaments and to delivery of copies thereof and hereby undertakes for the safe custody thereof And It is certified that the transaction hereby effected does not form part of a larger transaction or of a series of transactions in respect of which the amount or value or the aggregate amount or value of the consideration exceeds Five hundred pounds In witness whereof the said parties to these presents have hereunto set their hands and seals the day and year first before written.

The Schedule above referred to

First Part

All that close piece or parcel of land situate at Siddington within the said Manor and containing by admeasurement Two roods and twelve perches or thereabouts bounded on the West by land the property of Henry Bullock's Trustees on the North and East by land belonging to George Edward Monckton Esquire and on the South by the road leading from Siddington to Stoke Dry and which on the 1902 revised Edition of the Ordnance Survey is shown as N^o 187 containing two roods and twelve perches and which is now together with other lands in the occupation of Thomas Middleton which hereditaments were formerly described as "All that close piece or parcel of land or ground situate lying and being in Siddington aforesaid within the said Manor in a certain place there called Pig Lane containing by admeasurement two roods and five perches more or less and called or known by the name of Townsend Close One rood and thirty seven perches part thereof being an ancient Inclosure or Homestead whereon a Messuage Mansion House or tenement formerly stood and eight perches residue thereof was awarded to Robert Peach deceased upon the Enclosure of the open fields of Siddington aforesaid which said close or piece of land was lately in the

occupation of Jurell Manton and Adam Manton and then of Elizabeth Wright held by copy of Court Roll of the said Manor with other premises under the yearly rent of Five shillings

And also All that close piece or parcel of Pasture land situate at Siddington aforesaid within the said Manor formerly reputed to contain Two acres two roods and twenty six perches and bounded towards the North-east and North-west by land the property of Mr. Bullock and on all other sides by land the property of George Edward Monkton Esquire and approached towards the South-west by an accommodation Road leading from Siddington Village and forming the North-westerly portion of the field or enclosure numbered 6 on the 1902 revised edition of the Ordnance Survey And also all that piece or parcel of land situate at Siddington aforesaid within the said Manor and containing by admeasurement Twenty four acres and eleven perches formerly reputed to contain Twenty three acres one rood and two perches bounded on the North by the property of Mr. S. Taylor and on the East by the Hamlet of Thorpe by Water and on the South by the property of George Edward Monkton Esquire and on the West by the property of Mr. Bullock and which on the 1902 revised Edition of the Ordnance Survey is shown as No. 4 containing Eight acres one rood and six perches No. 5 containing Seven acres one rood and six perches No. 9 containing Eight acres one rood and thirty nine perches and which is now together with other land in the occupation of John Northern which hereditaments were formerly described as "All that close piece or parcel of Pasture land situate lying and being at Siddington aforesaid within the said Manor containing by admeasurement Two acres and three roods more or less Two acres two roods and twenty six perches thereof being two several ancient enclosures severally called or known by the name of Priostly Hill close & purchased by Robert Peach deceased of and from John Locke Esquire and fourteen perches the residue thereof was awarded to the said Robert Peach deceased upon the enclosure of the open and common fields of Siddington aforesaid And also All that

piece or parcel of land or ground situate lying and being at Liddington aforesaid within the said Manor in a certain place there before the Inclosure thereof called the Common containing by admeasurement Twenty three acres one rood and two perches or thereabouts (more or less bounded on the South-east by the Hamlet of Thorpe by Water on part of the South-west by an allotment made to Robert Walker Esquire on the remaining part of the South-west by the last described close of pasture land on the North-west by an allotment to Joseph Pretty and on the North by land allotted to Thomas Bryan which said last described piece or parcel of land or ground had been divided into three closes and were called or known by several names of the first part of Priestley Hill Top Priestley Hill Close and Barn Close held by copy of Court Roll under apportioned yearly rents of Six pence Five shillings Three shillings and four pence One penny One shilling and two pence One shilling and one penny half penny Four pence half penny Three pence

And also ^{all} those pieces or parcels of land situate at Liddington aforesaid within the said Manor and containing by admeasurement an area of Thirty nine acres two roods and seventeen perches and bounded on the North and part of the West by land belonging to George Edward Mondeton Esquire on the South and another part of the West by land belonging to Henry Bullock's Trustees and on all other sides by the Hamlet of Thorpe by Water and which is shewn on the 1902 revised Edition of the Ordnance Survey as part N^o 6 containing Sixteen acres and twenty nine perches N^o 7 containing Seven acres and thirty two perches and N^o 205 containing Five acres three roods and eight perches and N^o 207 containing Four acres two roods and eleven perches and N^o 204 containing Five acres three roods and eighteen perches now in the occupation of John Northern which hereditaments were formerly described as All that piece or parcel of land situate lying and being at Liddington aforesaid within the said Manor in a certain field there before the Inclosure thereof called the Mill Field and adjoining the before described land and premises and containing by

admeasurement Thuty eight acres and four perches more or less bounded on part of the East North and South-east and South-west by the Hamlet of Thorpe by Water on part of the West and on the remaining part of the South and East by land of the Marquess of Exeter and on part of the North-West by an ancient Homestead of Thomas Walker on further parts of the North West and on the South-west and part of the North-east in an irregular boundary by an ancient enclosure of Joseph Clarke on the remaining parts of the North and West by an ancient enclosure of Richard Burnington on further part of the North-west by Priestley Hill Lane on further part of the North-east and remaining part of the North-West by the said Close called Priestley Hill and on the remaining part of the North-East by the before described close containing Twenty three acres one rood and two perches and which lastly described piece or parcel of land or ground was then divided into five several closes called or known by the several names of Bridge Close Ruddled Leys Popes Close Long Cross and Bee Hill held by copy of Court Role of the said Manor under the yearly rent of Eight shillings and three pence halfpenny.

And also part of that piece parcel or close of Pasture land situate at Siddington aforesaid within the said Manor and containing by admeasurement Four acres and three roods bounded on the North-west by the property of Miss Langley and on the North-east by land the property of George Edward Monkton Esquire and on the South-east by land the property of M^{rs} Sprickley and on the South-west by premises adjoining the main street and forming the southerly portion of a field N^o 149 on the 1902 revised Edition of the Ordnance Survey and which is now in the occupation of J^r & Martin which hereditaments were formerly described as All that site of the east part of a Mansion House theretofore in the tenure of John Massey and two closes therunto adjoining in Siddington aforesaid and which said two closes are part of the old Inclosure and contain together Four acres two roods and two perches And also All that site of the West part

of a Mansion house in Siddington aforesaid formerly in the occupation of Phillippa Beely Widow with a Hay Barn little stable and half the yard thereto adjoining And also a way and passage for wagons or carts and horses with grain into and through the Barn door on the South side of the Barn erected by Thomas Barfoot for the more convenient emptying grain which said way and passage was formerly part of and reserved from the messuage and premises surrendered by Thomas Barfoot to Hugh Clarke and which messuage and premises were held together by two several rents of Two shillings and two pence and Two shillings and which way and passage are now held by the rent of One shilling and eight pence.

And also ^{all} those two pieces of arable land situate at Siddington aforesaid within the said Manor and containing by admeasurement Thirty one acres three roods and three perches and bounded on the East and North by land belonging to The Most Honorable the Marquess of Exeter and on the West towards the North by land belonging to Mr. Kirkbride and on the remaining parts of the West by land belonging to George Edward Stonkton Esquire and on the South by the Road leading from Siddington to Stoke Dry as shewn on the 1902 revised Edition of the Ordnance Survey and being N^o 165 containing Twenty two acres two roods and fourteen perches and 166 containing Nine acres and thirty three perches and now in the occupation of J. E. Marvin which hereditaments were formerly described as "All that plot or parcel of land in the Upper Field of Siddington aforesaid containing Thirty one acres two roods and four perches exclusive of the footway over the same bounded on or towards the East by allotments to Clement Marvin James Hill and John Wadland respectively on the South-west by the Stoke road and on the West and North by an allotment to the Marquess of Exeter

And also ^{all} those two pieces or parcels of Pasture land situate at Siddington aforesaid within the said Manor and containing by admeasurement Twenty six acres one rood and nine perches and bounded on the North-west by lands the property of Miss Sangley and Miss Satehell on the North-East

by the Parish of Seaton and on the South-East by land the property of the Ecclesiastical Commissioners on part of the South-west and on part of the South-east by land belonging to Mr. M. H. Stawson and on the remaining part of the South-west by land belonging to George Edward Monckton Esquire as shewn on the 1902 revised Edition of the Ordnance Survey and being N^o 140 containing Twelve acres and nineteen perches and 145 containing Fourteen acres and thirty two perches and now in the occupation of J. E. Marvin which hereditaments were formerly described as "All that plot or parcel of land in the Backside Pasture and common in Siddington, ^{aforsaid} containing Twenty six acres bounded on the North-east by the parish of Seaton on part of the South-east by the second allotment to the Prebendary for Gleebe and common right on part of the South-west and part of the South-east by an allotment to Francis Gibbons on the remaining part of the South-west by an old Inclosure belonging to John Moore and Thomas Moore and on the North^{ward} by allotments to John Sharman and John Pretty all which hereditaments were late in the occupation of Thomas Bryan deceased and then of William Sharman held by copy of Court Roll of the said Manor under eight yearly rents amounting together to Nineteen shillings and eight pence

And also ^{all} those pieces or parcels of Arable land situate at Siddington aforesaid within the said Manor and containing by admeasurement Twenty four acres two rods and two perches including an unenclosed piece of land used or formerly used as a public Stone Pit estimated to contain One acre or so, a small parcel of Freehold land situate to the North-east of and undivided from these said parcels of land containing by admeasurement an area of Three rods and thirty three perches or thereabouts the whole of which said pieces of land are bounded on the North and North-east by the road leading from Siddington to Stree Dry and on the West by the Road leading from Uppingham to Kettering and on all other sides by land belonging to George Edward Monckton Esquire as shewn on the 1902 revised

Edition of the Ordnance Survey as numbered 174 containing
 sixteen acres and twenty five perches and 230 containing eight
 acres one rood and seventeen perches and in the occupation of
 Thomas Middleton which hereditaments were formerly described
 as "All that allotment plot piece or parcel of land or ground
 in Liddington aforesaid within the said Manor in a certain
 field before the enclosure thereof called the Upper Field containing
 by admeasurement Twenty two acres two roods and sixteen perches
 bounded in parts of the North-east by the Mote Road on part of
 the South-east the remaining part of the North-east and on the
 North-west by an allotment set out for a public Stone Pit on the
 remaining part of the South-east by a freehold allotment to
 Robert Peach on the South-west by an allotment to Sarah Bissett
 and on the West by the Turnpike Road then in the occupation
 of the said Comyns Peach held by copy of Court Roll of the said
 Manor under the yearly rent of Two shillings and four pence

And also **A**ll that dwellinghouse with the outbuildings
 gardens and paddocks of Pasture land thereto adjoining
 situate at Liddington aforesaid within the said Manor and
 containing by admeasurement Two acres three roods and
 eleven perches or thereabouts bounded on the North by the
 Road leading from Liddington to Priestley Hills on another
 portion of the North and on a part of the West by land the
 property of George Edward Monckton Esquire and on the
 South by land the property of the Reverend St Bryan
 and on the West by other village property as shown on the 1802
 revised edition of the Ordnance Survey as Numbers part 193
 containing twenty one perches N^o 214 containing One acre
 three roods and nine perches and 214^a containing One rood
 and twenty four perches and 214 containing One rood and
 thirty seven perches in the occupation of M^{rs} Annie Keeman
 which hereditaments were formerly described as "All that
 Copyhold or customary messuage tenement or dwellinghouse
 with the yards gardens orchards homestead or home close
 and buildings thereto adjoining and belonging situate
 standing lying and being in Liddington aforesaid within

the said Manor heretofore said to contain altogether three acres but the same by admeasurement is found to contain three acres and twenty eight perches more or less formerly the estate of Edmund Simey Esquire late in the occupation of James Clarke and then of the Reverend Thomas Wheeler Esquire held by copy of Court Roll of the said Manor under the yearly rent of Two shillings

And also: **¶** That dwellinghouse with the outbuildings yard orchard and paddock of Pasture land thereto adjoining situate at Siddington aforesaid within the said Manor and containing by admeasurement One acre three roods and three perches and bounded towards the North-east by land the property of R. Clarke's Trustees towards the South-west by land the property of Henry Bullock's Trustees towards the South-East by the Road leading to Stoke Dry and on all other sides by land the property of George Edward Monckton Esquire as shown on the 1902 revised edition of the Ordnance Survey as numbers part 193 estimated to contain Two roods and fifteen perches and 186 containing One acre and twenty eight perches now in the occupation of Thomas Middleton which hereditaments were formerly described as "All that Copyhold messuage tenement or dwellinghouse with the yards barns stables outbuildings garden orchard homestead or home close thereto adjoining and belonging containing by admeasurement One acre two roods and sixteen perches more or less situate standing and being at Siddington aforesaid within the said Manor late in the occupation of Joseph Wright and then of Elizabeth Wright held by copy of Court Roll of the said Manor under the yearly rent of One shilling

And also: **¶** Those two pieces or parcels of Pasture land situate at Siddington aforesaid within the said Manor and containing by admeasurement Twenty acres one rood and ten perches and bounded on the North by land the property of M^{rs} Kirkbride and Miss Pretty on the South by lands the property of J. Manton the Reverend H. Bryan and H. every Bullock's Trustees and on all other sides by land the

property of George Edward Monckton Esquire as shewn on the 1902 revised edition of the Ordnance Survey as numbered 181 containing sixteen acres three roods and twenty nine perches and 185 containing three acres one rood and twenty one perches as at present in the occupation of Thomas Middleton which hereditaments were formerly described as "All those two copyhold closes plots pieces or parcels of land or ground situate at Siddington aforesaid within the said Manor heretofore one allotment or close but now divided into three closes and adjoining or lying near to the said messuage tenement or dwellinghouse or homestead or home close and running from the West end thereof containing together by admeasurement Nineteen acres two roods and twenty three perches more or less bounded on or towards North North-west and part of the North-east by land late of Godfrey Kemp on further part of the North-east by ancient enclosures of Joseph Clarke and the Marquess of Exeter on part of the South-east and on further part of the North-east by the said homestead or home close and on the South-west and the remaining part of the South-east and North-east by an ancient enclosure belonging to the Marquess of Exeter called Jesley Close on part of the South by land belonging to Thomas John Ryan and Adam Marston respectively and on the remaining part of the South and on the West by land of Mary Almond Widow late in the tenure of Henelm Wright and then of the said Elizabeth Wright held by copy of Goult Roll under yearly rents amounting together to the sum of Nine shillings and sixpence

And also ^QAll that close piece or parcel of arable land situate at Siddington aforesaid within the said Manor and containing by admeasurement three roods and fifteen perches and bounded towards the North and on the North East by the Hamlet of Therpe by Water and on the South-east by the Thorpe Lower Road and on the South-west and North-west by land the property of George Edward Monckton Esquire as numbered 45 on the 1899 revised edition of the Ordnance Survey and containing three roods and fifteen perches now in the occupation of J M Southern which hereditaments were formerly described as "All that close piece or parcel of land or ground situate lying and being at

Liddington aforesaid within and field of the said Manor in a certain field there before the Inclosure thereof called the North Field containing by admeasurement One acre and nine perches bounded on the North and part of the North-west by the Hamel of Thorpe by Water on the South-east by Thorpe Sewer Road and on the South-west and remaining part of the North-west by an attachment to Henry Sumpter all which said hereditaments were late in the occupation of William Harrison and then of John Thompson held by copy of Court Roll under the yearly rent of Two Shillings

And also All that cottage tenement or dwellinghouse with the outbuildings home close and piece or parcel of Pasture Land thereto adjoining situate at Liddington aforesaid within the said Manor and containing by admeasurement Ten acres and twenty perches or thereabouts and bounded towards the North-east and part of the North-west by the Road leading from Liddington to Stoke Dry and on the South-east by lands the property of Mess^{rs} Warwick and Richardson and Mess^{rs} J. Manton and the Glebe Land of the Parish of Liddington and on all other sides by land the property of George Edward Monkton Esquire as shewn on the 1902 revised edition of the Ordnance Survey and numbered part 193 One rood and twenty one perches 189 Three roods and seven perches and 224 Nine acres three roods and thirty two perches as at present in the occupation of J. E. Barnes which hereditaments were formerly described as "All that cottage tenement or dwellinghouse in Liddington aforesaid in a certain place called Figs Lane with the home close thereto adjoining containing by statute measure One acre and two perches late in the occupation of Catherine Drake and then of George Smith And also All that close piece or parcel of land or ground at Liddington aforesaid in a certain place there before the Inclosure thereof called the Middle field containing by statute measure Nine acres three roods and eight perches bounded on part of the North-east by the said Homestead on other part of the North-east by ancient

homesteads or enclosures in Siddington aforesaid of Richard Cunnington and Jovel Manton respectively on part of the South and remaining part of the North-east by land of Clarke Morris on the remaining part of the South East by land of the Vicar of Siddington aforesaid and part of the South-west by land late of Richard Cunnington on part of the North-west and remaining part of the South-west by land then or late of Sarah Drake Widow and on the remaining part of the North-west by the Road leading from Siddington aforesaid towards Stoke Dry late in the occupation of Mary Ellen Widow and then of the said George Smith held by copy of Court Roll under two several yearly rents of Three shillings and Two shillings and three pence.

And also **All** that piece or parcel of pasture land situate at Siddington aforesaid within the said Manor and containing by admeasurement thirteen acres and twenty one perches and bounded on the West by the road leading from Kettering to Uppingham and on the South by land the property of R. Gough and on all other sides by land the property of George Edward Monckton Esquire as shown on the 1902 revised edition of the Ordnance Survey and forming the westerly portion of a field N^o 231 containing by admeasurement eleven acres and one rood and in the occupation of Thomas Middleton which hereditaments were formerly described as "All that Copyhold or customary close piece or parcel of land or ground situate lying and being at Siddington aforesaid within the said Manor containing by admeasurement eleven acres and one rood or thereabouts be the same more or less bounded on the North-east by allotments to Robert Peach on the South-east by the freehold allotment made to Sarah Bassett on the South-west by an allotment to Thomas Bassett then the estate of Arthur Heathcote Esquire and on the North-west by the Turnpike Road leading from Kettering to Uppingham late in the occupation of Robert Freeman and then of the said George Peach held by copy of Court Roll under the yearly rent of Four shillings and six pence.

And also **All** that piece or parcel of pasture land situate at

Siddington aforesaid within the said Manor and forming the South-westerly portion of a field containing by admeasurement Seven acres two roods and seventeen perches and bounded towards the North-east by the road leading from Siddington to Uppingham on the South-east by land belonging to W J R Colwell and W Lukbride and on the South-west by a private road part of the North-west by freehold land the property of George Edward Monckton Esquire and on the North by land the property of W J R Colwell as shewn on the 1902 revised edition of the Ordnance Survey and forming the South-easterly portion of a field N^o 94 containing Seven acres two roods and seventeen perches and formerly estimated to contain Four acres one rood thirty one perches copyhold and Two acres three roods and thirty perches freehold as at present in the occupation of E E Clarke which hereditaments were formerly described as "All that piece or parcel of land or ground situate lying and being at Siddington aforesaid within the said Manor in a certain place there before the Inclosure thereof called the Brand containing by statute measure four acres one rood thirty one perches bounded on parts of the North East and North West by land of Elijah Sharman on the remaining part of the North-east by the Uppingham Road and on the South east by allotments awarded to John Colwell and Robert Clarke on the South-west by a private road and on the remaining part of the North-west by freehold land heretofore belonging to William Wright and by him sold and conveyed to the said John Monckton deceased and together with the said piece of freehold land then formed one close in the occupation of William Wright

And also All that piece or parcel of pasture land situate at Siddington aforesaid within the said Manor and containing by admeasurement Three acres one rood and twenty eight perches and bounded on the North-east by freehold lands of J M Northern and Miss J. Brown and on the South-East by a road leading from Siddington to Bisbrook and on the South-west by lands the property of J E Marwin J M Northern and W^o Clarke and on the

North by the Parish of Uppingham as numbered 75 on the 1902 revised edition of the Ordnance Survey and containing three acres one rood and twenty eight perches as now in the occupation of *E. E. Clarke* which hereditaments were formerly described as "All that close piece or parcel of land or ground situate lying and being at Liddington aforesaid within the said Manor in the said place called the Brand containing by statute measure three acres one rood and six perches bounded on the North-east by freehold land of Thomas Lacton Robert Clarke and Thomas Wadland on the South-east by the Brook Road and on the South-west by land of John Clarke Samuel Pretty and the devisees of the late William Brown deceased and on the North-west by the Parish of Uppingham and then in the occupation of the said William Wright held by copy of Court Roll of the said Manor under the yearly rent of One Shilling and three pence

And also All that dwellinghouse cottage or tenement with the outbuildings orchard garden and paddock of pasture land adjoining situate at Liddington aforesaid within the said Manor and containing by admeasurement Three roods and thirty four perches and bounded on the East by the main Village Street and on the South by the Road leading from Liddington to Stoke Fry on the West by land the property of George Edward Monkton Esquire and on the North by land the property of *R. Clarke's Trustees* and on the North-east by other village property as shewn on the 1902 revised edition of the Ordnance Survey as part N^o 193 containing three roods and thirty four perches now in the occupation of *R. W. Clements* which hereditaments were formerly described as "All that messuage cottage or tenement situate standing and being at Liddington aforesaid within the said Manor with the barns Stables outbuildings and appurtenances to the same belonging

And also All that homestead orchard or small close or enclosed piece or parcel of land near to or adjoining the said messuage or tenement then in the occupation of James Clements held by copy of Court Roll of the said Manor under the yearly rent of One Shilling and six pence

And also ^{all} that piece or parcel of pasture land situate at Liddington aforesaid within the said Manor and containing by admeasurement Eleven acres one rood and thirty two perches and bounded on the North by the road leading from Liddington to Stoke Try on the South by Glete Sand of the Parish of Liddington and on all other sides by freehold and copyhold lands belonging to George Edward Monckton Esquire ^{as numbered 224 on the 1902 revised Edition of the Ordnance Survey} and containing Eleven acres one rood and thirty two perches in the occupation of R. W.

Elements which hereditaments were formerly described as "All that close or piece ^{of} land situate lying and being at Liddington aforesaid within the said Manor in a certain place before the Inclosure thereof called the Upper Field containing Eleven acres and twenty six perches and formerly estimated to contain Eleven acres three roods and thirty four perches bounded on the South-east by land heretofore of Thomas Lunnington but late of the said John Monckton deceased on the South-west by the first allotment to the Vicar of Liddington on the North-west by an allotment made to Sarah Bassett purchased by the said John Monckton and on the North by the Stoke Road then in the occupation of the said James Elements held by copy of Court Roll under the yearly rent of Two shillings and ten pence half penny.

And also ^{all} that piece or parcel of Pasture land situate at Liddington aforesaid within the said Manor and containing by admeasurement Four acres three roods thirty seven perches and bounded on the North by the road leading from Liddington to Stoke Try and on all other sides by land belonging to George Edward Monckton Esquire as numbered 225 on the 1902 revised edition of the Ordnance Survey and containing four acres three roods and thirty seven perches now in the occupation of R. W. Elements which hereditaments were formerly described as "All that close or piece of land situate lying and being at Liddington within the said Manor in a certain field there before the Inclosure thereof called the Middle Field containing by statute measure Four acres three roods and fifteen perches bounded on the North by the Stoke Road on the East and South-east by an allotment to Hannah the Wife of John Seaton late the estate

of the said John Monckton and on the South-west and North-west by an allotment to Thomas Cunnington late the estate of the said John Monckton then in the occupation of the said James Elements held by two several copies of Court Roll under two several yearly rents of Five pence and One penny

And also ^{Q. 11} that close piece or parcel of pasture land situate at Siddington aforesaid within the said Manor forming the North-westerly corner portion of a field containing by admeasurement Ten acres and thirteen perches bounded on the north by the road leading from Siddington to Stoke Dry and on the South-east by Glebe land of the Parish of Siddington and on all other sides by land the property of George Edward Monckton Esquire and estimated to contain One acre two rods and fourteen perches being part of a field number 226 on the 1902 revised edition of the Ordnance Survey as at present in the occupation of Thomas Middleton which hereditaments were formerly described as "All that piece or parcel of copyhold land or ground at Siddington aforesaid within the said Manor in a certain field there before the Inclosure thereof called the Upper Field containing by admeasurement One acre two rods and fourteen perches more or less bounded on the North-east by the Stoke Road and on the South-east and South-west by an allotment made to Thomas Cunnington deceased and next hereinafter described and on the North-west by an allotment made to John Allen and then in the occupation of the said Elizabeth Wright but late to Sarah Drake held by copy of Court Roll of the said Manor under the yearly rent of Nine pence

And also ^{Q. 12} those pieces or parcels of pasture land situate at Siddington aforesaid within the said Manor and forming the South-westerly portions of two enclosures of land bounded on the North by the Road leading from Siddington to Stoke Dry on the South part of the South-east and part of the South-west by the Glebe land of the Parish of Siddington and on all other sides by land belonging to George Edward Monckton Esquire and being partly unenclosed portions of Numbers 226 and 233 on the 1902 revised edition of the Ordnance Survey and

estimated to contain by admeasurement an area of five acres and ten perches as at present occupied by Thomas Middleton which hereditaments were formerly described as "All that other piece or parcel of land or ground situate at Liddington aforesaid within the said Manor in certain fields there before the Inclosure thereof called the Upper Field and Middle Field containing by admeasurement Five acres and ten perches bounded on part of the North-east by an allotment to Thomas Cunningham deceased lastly heretofore described on part of the South-east on the East and remaining part of the South-east and on the South-west by an allotment to the Vicar of Liddington and Caldecott and on the North-west by an allotment to John Allen late the Estate of Sarah Drake in the occupation of the said Elizabeth Wright held by copy of Court Roll under the apportioned yearly rent of One shilling.

And also **All** that piece or parcel of pasture land ^{situate} at Liddington aforesaid within the said Manor and containing by admeasurement Two acres and bounded on the North by an accommodation Road leading from Liddington to Pucotley Hill and on all other sides by land the property of George Edward Monkton Esquire as numbered 208 on the 1902 revised Edition of the Ordnance Survey and containing by admeasurement Two acres or thereabouts as at present in the occupation of J & Baines which hereditaments were formerly described as "All that piece or parcel of land or ground situate at Liddington aforesaid within the said Manor and containing by admeasurement One acre three rods and twenty nine perches more or less called or known by the name of Thorney or Spinnery Close then in the occupation of the said George Smith held by copy of Court Roll of the said Manor under the yearly rent of One shilling and three pence

And also **All** that piece or parcel of pasture land situate at Thorpe by Water aforesaid within the said Manor and containing by admeasurement Thirteen acres and thirty four perches and bounded on the North by land belonging to George Edward Monkton Esquire and an occupation road leading to Thorpe

Mill on the East by the London and North Western Railway on
 the West by the Road leading from Thorpe by Water to Caldecott
 and on the South by an accommodation Road as numbered 58
 on the 1902 revised edition of the Ordnance Survey containing by
 admeasurement Thirteen acres and thirty four perches as at
 present in the occupation of J. M. Northern and
 also one other piece or parcel of pasture land situate at Thorpe
 by Water aforesaid within the said Manor and containing by
 admeasurement seventeen acres and eleven perches bounded
 on the North by an accommodation Road on the East by the
 London and North Western Railway and on the South by the
 Parish of Siddington and on the West by the Road leading from
 Thorpe by Water to Caldecott as numbered 78 and 79 on the
 1902 revised edition of the Ordnance Survey and containing
 by admeasurement seventeen acres and eleven perches as at
 present in the occupation of J. M. Northern and
 also all that close piece or parcel of pasture land situate
 at Thorpe by Water aforesaid within the said Manor and
 containing by admeasurement sixteen acres three roods and
 sixteen perches bounded on the East by the Road leading from
 Thorpe by Water to Caldecott on the South by the Parish of
 Siddington on the West by land the property of J.
 Ward and on the North by land the property of George
 Edward Monckton Esquire and which on the 1902 revised
 edition of the Ordnance Survey is shown as part No 56 which
 is now in the occupation of Thomas Northern which
 hereditaments were formerly described as "All that plot
 piece or parcel of land in Thorpe by Water aforesaid"
 containing by admeasurement Thirteen acres two roods and
 eight perches bounded on the East by the Rugby and Stamford
 Branch Railway on the West by the Road to Caldecott or part
 of the North by an ancient enclosure belonging to the said
 George Monckton and on the remaining parts of the North by
 an occupation Road leading to the Water Mill And also one
 other plot piece or parcel of land in Thorpe by Water aforesaid
 containing by admeasurement Fifteen acres one rood and

thirty six perches and bounded on the East by the said Railway and on the West by the said Road from Thorpe by Water to Caldecott on the North by an occupation Road and on the South by the Lordship of Siddington and also all that other plot piece or parcel of land or ground in Thorpe by Water aforesaid containing by admeasurement sixteen acres three roods and sixteen perches bounded on the East by the said road from Thorpe by Water to Caldecott on the West by an allotment to the Earl of Harborough on the North by a freehold allotment to the said George Monckton made in lieu in severances purchased of the said Railway Company and on the South by the Lordship of Siddington aforesaid which three several allotments were set out and allotted upon the Inclosure of Thorpe by Water in lieu of and as compensation for all the said open field fields land and rights of common to which the said John Monckton deceased was admitted Tenant as aforesaid on the surrender of the said Elizabeth Redshaw and William Davies Joseph Davies and John Smith except one acre two roods and twenty perches part thereof which was sold by the said John Monckton deceased to the London and North Western Railway Company"

And also All that piece or parcel of Pasture land situate at Siddington aforesaid within the said Manor and containing by admeasurement Nineteen acres three roods and twenty four perches and bounded on the North-east by land the property of George Edward Monckton Esquire and the Parish of Thorpe by Water on the South by an irregular boundary intersecting it from Siddington Glee Land on the South-west by land the property of W. J. Hays and on the North-west by the Road leading from Thorpe by Water to Caldecott and intersected by the London and North Western Railway as shown on the 1902 revised Edition of the Ordnance Survey and numbered 41 and 38 respectively and containing eleven acres three roods and twenty eight perches and seven acres three roods and thirty five perches respectively as at present on the occupation of Thomas Northern, which hereditaments

were formerly described as "All that plot or parcel of land in the Manor field of Siddington aforesaid containing eighteen acres and twenty one perches which was set out by the Commissioners appointed to enclose the open and common fields of Siddington aforesaid for and in lieu of so much of the said two half yardo lands as were in Siddington aforesaid and which said allotment was bounded on the South-east part of the North-east and on the North by an allotment to Henry Baines on further part of the North-east by the Hamlet of Thorpe by Water on the South (in an irregular boundary) by the second allotment to the Vicar on the South-west by an allotment to John Chapman and on the North-west and on the remaining part of the North-east by Thorpe Lower Road late in the occupation of the said Elizabeth Redshaw and then of Thomas Hill

And also ¹⁹ that close piece or parcel of Pasture land situate at Siddington aforesaid within the said Manor and containing by admeasurement Five acres two roods and thirty three perches and bounded on the North and North-east by the Parish of Thorpe by Water and on all other sides by land the property of George Edward Moulton Esquire and intersected by the London and North Western Railway as numbered 39 and 40 on the 1902 revised Edition of the Ordnance Survey and containing four acres and thirty one perches and One acre three roods and one perch respectively as at present in the occupation of Mess^{rs} J. M. and J. Northern which hereditaments were formerly described as "All that close piece plot or parcel of land or ground situate lying and being in Siddington aforesaid in a place there called "The Meadow" containing six acres one rood and twenty two perches formerly in the occupation of William Merrill and then of John Pretty bounded on or towards the North-east and part of the South by the Hamlet of Thorpe by Water on the remaining part of the South on the South-west and part of the North by an allotment on the enclosure of the common and open fields of Siddington aforesaid made to Mary Baxter late the

property of the said Elizabeth Redshaw since sold to the said John Monckton and on the remaining part of the North-west by the end on Thorpe Lower Road held by copy of Court Roll under the yearly rent of

And also **All** that piece or parcel of pasture land situate at Siddington aforesaid within the said Manor bounded on the North-east by the Parish of Thorpe by Water and land the property of George Edward Monckton Esquire on the South-east by the Road from Thorpe by Water to Caldecott on the South-west by land the property of George Edward Monckton Esquire and on the North-west by land the property of Miss Satchell and being part of N^o 46 on the 1902 revised Edition of the Ordnance Survey and containing five acres or thereabouts as at present in the occupation of Thomas Northern which hereditaments were formerly described as "All that close piece or parcel of land or ground situate lying and being at Siddington aforesaid within the said Manor containing by admeasurement five acres or thereabouts little more or less bounded on part of the North-east by the Hamlet of Thorpe by Water on part of the South-east and remaining part of the North-east by land of Mary Sumpter on the remaining part of the South-east by the Thorpe Lower Road and on the South-west and North-west by land of Henry Waines late in the occupation of Henry Allan and then of John Pretty held by copy of Court Roll under the yearly rent of

And also **All** that close piece or parcel of pasture land situate at Siddington aforesaid within the said Manor bounded on the North-east by land the property of George Edward Monckton Esquire and on the South-east by the Road leading from Thorpe by Water to Caldecott on the South-west by land the property of W. J. Stave and on the North-west by land the property of Miss Satchell and being the remaining part of N^o 46 on the 1902 revised Edition of the Ordnance Survey and containing six acres and twelve perches as at present in the occupation of Thomas Northern which hereditaments were formerly described as "All that close piece

or parcel of land or ground situate lying and being at
 Siddington aforesaid and containing by admeasurement
 six acres and twelve perches or thereabouts more or less being
 the Scot part of a certain allotment of land containing fourteen
 acres three roods and three perches made to the said Henry
 Baines upon the enclosure of the common and open fields of
 Siddington aforesaid in lieu of certain open field lands and
 common rights to which the said Henry Baines was admitted
 Tenant at a bowel held in and for the said Manor on the
 thirtieth September One thousand seven hundred and seventy
 five and thence continued by adjournment to the first April
 following as youngest son and customary heir of Thomas
 Baines his late father bounded on part of the South-east and
 part of the North-east by land theretofore of Henry Sumpter and
 late of William Ableby on further part of the South-east by
 Thorpe Sower Road and on part of the South-west and remaining
 part of the South-east by land of John Chapman and on the
 North-east by other part of the said allotment made to the said
 Henry Baines late in the occupation of Henry Allen and then
 of the said John Petty held by copy of bowel Roll of the said
 Manor under the apportioned yearly rent of One shilling and
 six pence"

Second Part

All and so much as is not included and described in the
 first part hereof of and in All that one customary messuage
 or tenement situate in Thorpe by Water in the County of Rutland
 with the yards gardens homesteads and closes of pasture thereto
 adjoining and belonging containing together seven acres and
 three roods or thereabouts more or less late in the tenure or
 occupation of Elizabeth Redshaw and then of William Worthen
 And also the following pieces or parcels of arable land ley
 meadow and pasture ground situate in the open fields precincts
 and territories of Thorpe by Water aforesaid containing according
 to a survey and admeasurement the several quantities following
 (that is to say) in the Great Field One land in Stone Wash

Furlong Thirty four perches. Three lands in the same Furlong
 One acre one rood and three perches One other land in the same
 Furlong Thirty perches. Two lands in How Bottom Furlong
 Three roods and eleven perches. One land in the same Furlong
 One rood and eight perches. Two other lands in the same
 Furlong Two roods and six perches One land in Thorough
 lands Two roods and seven perches. Two other lands there
 One acre and twelve perches One other land there One rood
 and thirty four perches. One land in the middle of the field,
 One rood and thirty five perches. Two other lands there One
 acre and eight perches. One land in March Dike Leys One rood
 Ten lands in Peas Holm Furlong Two acres and nineteen perches.
 Three lands in Roadside Furlong two roods and seven perches
 and Three lands in Chapmans Piece Furlong Two roods and
 twenty four perches. In the Nether Field one land in New
 Leys Furlong one rood and three perches. Two lands in
 Church Way Furlong two roods and thirty eight perches
 and one land in Wards Leys one rood. In the Middle
 field One land in Fox Barrow thirty four perches. Two other
 lands there three roods and thirty four perches. One land
 in Longhams Baulk Furlong. One rood and fourteen perches
 One other land there One rood and twenty three perches.
 Three other lands there Three roods and thirteen perches.
 Head land there One rood and six perches. Three other
 lands there One acre and thirty seven perches. Three lands
 in Sheep lot Furlong three roods and thirty five perches.
 One other land there One rood and nine perches. Six lands
 in Wanbillings Pad Furlong One acre one rood and twelve
 perches. One land in Uffingtons Close Furlong thirty eight
 perches. Two other lands there One rood and thirty seven
 perches. Six lands under the Hill One acre. Fourteen lands
 in Upper Breach six acres and twenty eight perches and
 two lands in Bottom Breach two roods and thirty perches
 and a piece in Marsh Meadow containing One acre
 one rood and thirty five perches all which said lands
 make together twenty eight acres two roods and twelve

perches little more or less being so much of two half yard lands (copyhold) of arable meadow pasture and ley ground lying and being in the fields precincts and territories of Thorpe by water and Siddington in the said County of Rutland as remained unenclosed but have since been enclosed and which two half yard lands were estimated to contain before the inclosure of Siddington Sixty acres (more or less) late in the tenure of William Redshaw deceased and since of the said Elizabeth Redshaw or her assigns.

And also All those several pieces or parcels of arable meadow and pasture land situate lying and being in the fields and liberties of Thorpe by Water aforesaid within the said Manor part and parcel of one yard land held by copy of Court Roll under the yearly rent of seven shillings and six pence which said pieces or parcels of land or ground are hereinafter more particularly described (that is to say) In the East Field two lands in Bridge Furlong Lady Morgan North-west and M^{rs} Kilburn South-east containing by admeasurement One acre Three lands in Warrens Clove Furlong M^{rs} Juniper South-east John Monckton Esquire North-west two roods and thirty nine perches. Two lands in Lamb Bank Furlong Lady Morgan North-west and the said John Monckton South-east three roods and twelve perches. Two lands in Orchard Furlong Lady Morgan South-east and North-west two roods and thirty seven perches. One other land in the same Furlong One rood and twenty three perches. In the North field Two lands in Lamb Bank Furlong Lady Morgan South-east and M^{rs} Kilburn North-west two roods and thirty perches. Four lands in Crab Tree Hedge Furlong John Monckton South Lady Morgan East three roods and twenty eight perches. Four lands in Breach Furlong Lady Morgan North-west and the said John Monckton North-west One acre and thirty nine perches. In the West Field. Two lands in Slices Noke Furlong Joseph Drake South-east and Henry Allen North-west One rood and thirty two perches. Four lands in Seas Holm Furlong Lady Morgan east and west. Two roods

thirty two perches. A Head land in Song Bottom Furlong Lady
 Morgan East and West One rood and eighteen perches. Two
 lands in Water Bank Furlong John Monckton East and William
 Ashby West Three roods and four perches. Four lands in Bay Hill
 Furlong Joseph Drake East and West two roods and ten perches
 Two lands in the same Furlong Lady Morgan East and West
 One acre and five perches. One land in the same Furlong Lady
 Morgan South-east and Robert Freeman North-west One rood
 and eighteen perches part of a close called Merrills Close (the
 other part being freehold) John Monckton West Lady Morgan
 South-east Two acres two roods and twenty one perches. A piece
 of Ley ground in March Tyke Lays Lady Morgan East and West
 Two roods and thirty two perches. Three Lays more there (Song
 Bottom) One rood and twenty eight perches. Two other Lays in
 March Tyke Lays (Shou Bottom) Two roods and thirty eight
 perches Five Lays under Bay Hill Furlong Lady Morgan South
 west and South-east One acre one rood and fourteen perches.
 A piece of land in Tugden Meadow Lady Morgan East and
 West Three roods and thirty one perches. Another piece of
 meadow land in the same Meadow Lady Morgan East.
 Samuel Drake West Wadeston North-west and Tugden Furlong
 South-east One acre two roods and nine perches and one
 other piece of meadow land in March Meadow Lady Morgan
 East and West One rood and two perches together with four
 horse commons four cow commons and fifty sheep commons
 to be had and taken in the common and open fields of
 Thorpe by Water aforesaid held by copy of Court Roll of the
 said Manor under the yearly rent of Seven shillings and
 six pence and to which the said John Monckton deceased
 was admitted Tenant at a general Court held in and for
 the said Manor on the twenty fourth day of April One thousand
 eight hundred and twenty seven on the surrender of William
 Barnes Joseph Barnes and John Smith

And also **ALL** that Barn and small Building adjoining
 formerly a stable and the yard with the fence walls on
 the East North and South sides thereof situate standing and

being at Siddington aforesaid containing by admeasurement
Twenty five perches

And also ^{all} that piece of ground at Siddington aforesaid
adjoining the said last mentioned premises containing One
rood and twenty perches with the fence on the South side thereof
which divides the same from the Home Close of Robert Clarke

And also ^{all} those two Copyhold cottages or tenements with
the outbuildings yards gardens and appurtenances thereto
belonging situate standing and being in the Parish of
Siddington aforesaid at or near the Townshipe of Thorpe by Water
aforesaid and within and held of the said Manor theretofore
in the occupation of Thomas Parson and William Burrows since
of John Stevenson and Amos Baines and then of William
Thorpe and Thomas Smith adjoining the Highway leading to
Thorpe Mill held by copy of Court Roll of the said Manor
under the yearly rent of One penny and to which the said
John Monekton deceased was admitted Tenant at a General
Court held in and for the said Manor on the seventh day of
May One thousand eight hundred and forty on the Surrender
of John Woolston the Younger

And also ^{all} that messuage or tenement in Siddington
aforesaid formerly in the tenure of Elizabeth Sewell Widow

And also ^{all} that messuage cottage or tenement with
the outbuildings yard garden orchard and appurtenances
thereto belonging including eight perches of land in front
of the said messuage cottage or tenement situate standing and
being at Siddington aforesaid within the said Manor late
in the occupation of Mary Wadland and then of Conyers
Peach or his undertenant Thomas Wade and held by copy
of Court Roll under the yearly rent of Three shillings and
nine pence

And also ^{all} those three undivided fourth parts the whole
into four equal parts or shares being considered as divided
of and in ^{all} that messuage or tenement with the yard
garden and orchard heretofore called the homestead or close
of pasture thereto adjoining situate standing and being in

Thorpe by Water aforesaid within the said Manor and in the Parish of Siddington aforesaid And of and in All that close of pasture in Thorpe by Water aforesaid within the said Manor and the Parish of Siddington aforesaid heretofore said to contain by estimation three acres more or less but by admeasurement found to contain Two acres and one rood called or known by the name of Dopes Close or Tea Close

And also All that site of All that copyhold Messuage or tenement with the appurtenances situate and being at Siddington aforesaid within the said Manor formerly in the occupation of William Farmer afterwards of John Askew and then the site of the said messuage or tenement is in the occupation of the said George Smith held by copy of Court Roll of the said Manor under the yearly rent of Two pence

And also All that Orchard or piece of copyhold land at Siddington aforesaid within the said Manor called the Homestead formerly in the occupation of John Hill and then of the said Elizabeth Wright held by copy of Court Roll under the yearly rent of Two shillings and eight pence and to which the said John Monckton deceased was admitted Tenant at the same Court on the surrender of the said Thomas Bannington

And also All those two copyhold or customary messuages or tenements with the outbuildings and appurtenances to the same belonging situate standing and being in Siddington aforesaid within the said Manor in a certain place there called Pigs Lane late in the occupation of Francis Baker and John Gilbey and then of Thomas Gilbey and Thomas Webster held by copy of Court Roll under the yearly rent of Six pence half penny and to which the said John Monckton deceased was admitted tenant at a general Court held in and for the said Manor on the twenty eighth day of May One thousand eight hundred and forty six on the surrender of William Barnes

And also All that messuage or cottage some time since

divided into two tenements situate standing and being
 at Liddington aforesaid within the said Manor heretofore
 in the occupation of John Kiss and Thomas Broughton
 afterwards of Thomas Wright late of Samuel Drake and then
 of ^{Elizabeth} Elizabeth Wright or her undertenant held by copy of
 Court Roll under the yearly rent of Two pence and to which
 the said John Monckton deceased was admitted Tenant at
 the same Court on the Surrender of Samuel Drake

And also ^{that} one undivided fourth part of the whole
 into four equal parts being considered as divided of and in
 all that messuage or tenement with the yard garden and
 orchard heretofore called the homestead or close of pasture
 thereto adjoining situate standing and being at Thorpe by
 Water within the said Manor and the Parish of Liddington
 aforesaid & Exeter ^{Co} Signed sealed and delivered by the
 before named Marquess of Exeter in the presence of Geo. H.
 Mutter, Land Agent Stamford.

Examined by me,

Rowland Kelly

Steward.

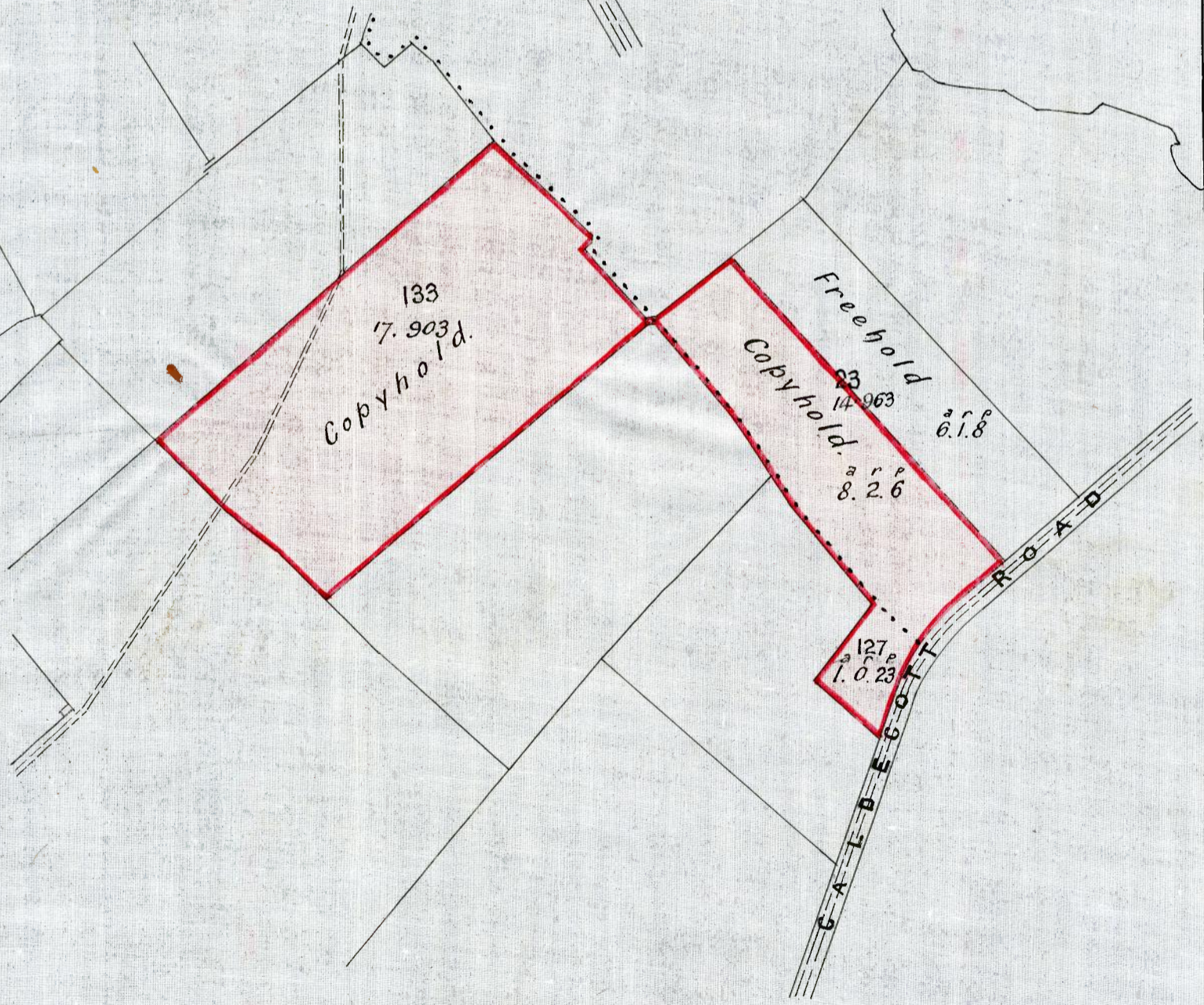
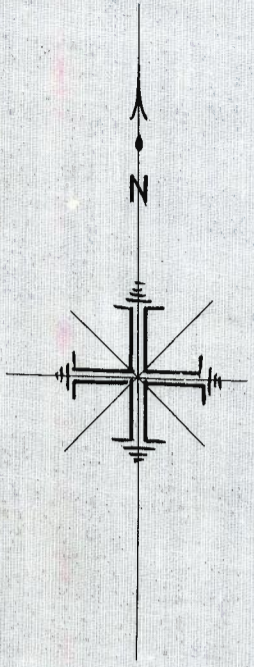
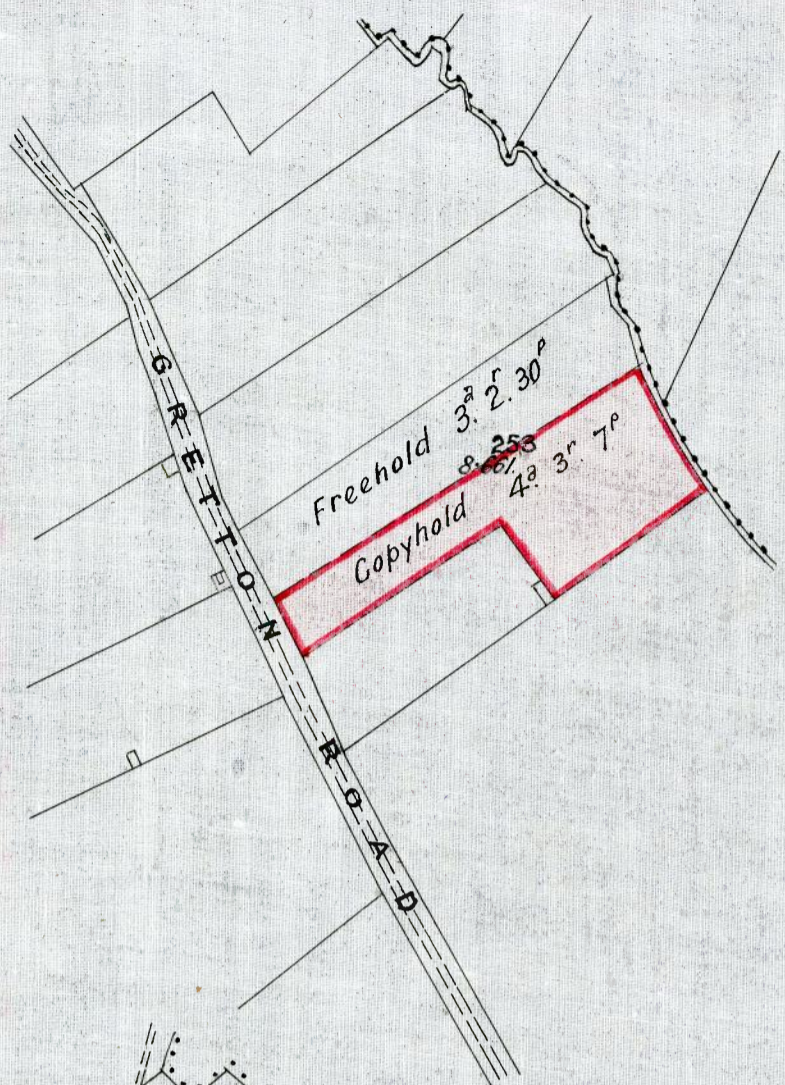

This Indenture made the fourteenth day of
 December One thousand nine hundred and seventeen
 The Most Honorable William Thomas Brownlow
 Marquess of Exeter Baron of Bughley (hereinafter called
 "the Marquess") of the one part and John Henry Monckton
 of Meiden near Coventry in the County of Warwick a Colonel
 (retired) in His Majesty's Army of the other part Whereas the
 Marquess is seized in fee simple of the Manor of Liddington with
 Caldecott in the County of Rutland And whereas at a Court
 held on twentieth August One thousand eight hundred and
 eighty five the said John Henry Monckton (together with
 Claud Monckton and Arthur Monckton now respectively
 deceased) was admitted Tenant in customary fee of the
 hereditaments described in the first Schedule hereto on the
 Surrender of Charles Swann Shield under the several yearly
 rents of six pence One shilling and six pence and One shilling
 and six pence And whereas on the twenty third January
 One thousand nine hundred and seventeen the said John
 Henry Monckton (together with the said Arthur Monckton) was
 admitted Tenant in customary fee of the hereditaments described
 in the second Schedule hereto and shown on the plan drawn
 on these presents by way of identification only and thereon
 coloured Pink on the Surrender of Francis Monckton under
 the several yearly rents of Four pence Two shillings and two
 pence One shilling and nine pence Two shillings Two shillings
 and four pence Six pence and seven pence three farthings
 And whereas the Marquess has agreed with the said John
 Henry Monckton for the enfranchisement of the said hereditaments
 for the sum of Seventeen pounds two shillings and ten pence
 Now this Indenture witnesseth that in consideration of
 Seventeen pounds two shillings and ten pence to the
 Marquess paid by the said John Henry Monckton on or before
 the execution of these presents (the receipt whereof the Marquess
 doth hereby acknowledge) The Marquess as Beneficial Owner
 hereby enfranchises and conveys to the said John Henry Monckton
 All the hereditaments and premises described in the Schedule

Stamp
2/-

Ind. Monckton
15.12.17

herunder written Together with the appurtenances except the rights reserved by the Copyhold Act 1894 Section 23 to hold the same as freehold free and discharged from all rents fines suits and services and other incidents of copyhold tenure except as aforesaid unto and to the use of the said John Henry Monckton in fee simple And the Marquess hereby acknowledges the right of the said John Henry Monckton to production of the Court Rolls so far as they relate to the said hereditaments and to delivery copies thereof and hereby undertakes for the safe custody thereof And it is certified that the transaction hereby effected does not form part of a larger transaction or of a series of transactions in respect of which the amount or value or the aggregate amount or value of the consideration exceeds Five hundred pounds In witness whereof the said parties to these presents have hereunto set their hands and seals the day and year first before written

The first Schedule above referred to

All that close piece or parcel of land situate at Siddington aforesaid within the said Manor and containing by admeasurement sixteen acres two roods and twenty perches and bounded on the South by the road leading from Siddington to Stoke Dry on part of the East by land the property of M^{rs} J. Manton on part of the North by land the property of M^{rs} Hulbridge and on all other sides by land the property of George, Edward and Monckton Esquire as shewn on the 1902 revised Edition of the Ordnance Survey being Numbers 178 containing nine acres three roods and six perches and 179 containing six acres three roods and fourteen perches as at present in the occupation of J. & Marvin which hereditaments were formerly described as "All that allotment piece or parcel of land containing two acres and one rood situate lying and being in Siddington in the said County of Rutland within the said Manor and also All that one other allotment lying near to the said last described allotment of land containing seven acres and one perch

formerly in the occupation of Mary Almond and afterwards of her son John Almond held by copy of Court Roll of the said Manor under the yearly rents of Six pence and One shilling and six pence And also **All** that close piece or parcel of land containing Seven acres one rood and one perch situate lying and being in Siddington aforesaid within the said Manor formerly in the occupation of the said Mary Almond and one Alice Wadland and afterwards of the said John Almond afterwards of Hugh Drake the Younger and now or late of **held** by copy of Court Roll of the said Manor under the yearly rent of One shilling and six pence which said three allotments had theretofore been said to contain altogether by admeasurement Sixteen acres and one rood but by a recent survey thereof were found to contain altogether Sixteen acres two roods and twenty perches (more or less)

— The second Schedule above referred to —

All that piece of old pasture land situate at Siddington within the said Manor containing Four acres three roods and thirty six perches and formerly reputed to contain Four acres three roods and seven perches bounded on the East by the boundary of the Parish of Thorpe by Water and Land of **J** Ward on the West in part by the Road from Siddington to Gretton and on the remainder of the West and on the South by lands of **H** Freeman and **H** Bullock and on the North by land of George Edward Monckton and forming the southerly portion of the field or enclosure No. 253 on the 1902 revised Edition of the Ordnance Survey and now in the occupation of **H** Clark which hereditaments were formerly described as being bounded on part of the South by land of Mary Barfoot on the West and remaining part of the South by land of Clement Pretty and the Gretton Road and on the North by freehold land awarded to Edward Crane and are held under the yearly rent of Four pence

Also ^Q that piece or parcel of old pasture land situated in which was formerly known as the Middlefield in the Parish of Siddington and extending as to a small portion thereof into the Parish of Baldecott within the said Manor containing eight acres two roods and twenty six perches or thereabouts and formerly reputed to contain eight acres two roods and twelve perches lying to the North West of the road from Baldecott to Thorne by Water forming the South West portion of a field or enclosure N^o 23 on the 1902 revised Edition of the Ordnance Survey now in the occupation of R J Ward which hereditaments were formerly described as being bounded on the North East by freehold lands allotted to John Cugden on the South East by the Baldecott Road on the South West by lands allotted to Thomas Bryan and are held under the yearly rents of Two shillings and two pence and One shilling and nine pence

And also ^Q that piece or parcel of land situated and being in what was formerly known as the Middlefield of Baldecott within the said Manor containing Nineteen acres and seven perches (in the Surrender of the same erroneously mentioned as containing Twenty seven acres two roods and thirty three perches) bounded on the North East by the parish boundary between Baldecott and Siddington and which in the 1902 Revised Edition of the Ordnance Survey is shown as N^o 127 containing One acre and twenty three perches and N^o 133 containing Seventeen acres three roods and twenty four perches made up of pieces or parcels formerly reputed to contain Fifteen acres three roods and thirty four perches and One acre which hereditaments were formerly described as "A piece of land in the Middlefield containing One acre and twelve perches bounded on the North West by the first allotment made on the enclosure of Baldecott to Mary Baxter on the North East by the Parish of Siddington on the South East by the Siddington Road and on the South West by the second allotment made to the said Mary Baxter And also a piece of land in the Middlefield containing

Fifteen acres three rods and thirty five perches bounded on the North West by the second allotment to the Marquess of Exeter on the North East by the Parish of Liddington on part of the South East by the first allotment to the Vicar for tithes on part of the South West and remaining part of the South East by the next described piece of land and on the remaining part of the South West by the first allotment to John Walker And also a piece of land in the Middlefield containing One acre set out by the Commissioners on the said enclosure in lieu of copyhold Meadow and subject to modur bounded on the North East and North West by the last described piece of land on the South East by the first allotment to John Walker held by copy of bond Roll under the several yearly rents of Two shillings Two shillings and six pence Six pence and Seven pence three farthings - Exeter © Signed sealed and delivered by the before named Marquess of Exeter in the presence of Geo. H. Mutter Land Agent Stamford.

Examined by me,

Chewmulyeth
Steward.

Involvement of Will of
George Warren Lamb.

This is the Last Will and Testament of me George Warren Lamb of Dulborough in the County of Sussex Gentleman

1. I give all my property of every description (except the mortgaged copyhold Land hereinafter devised) to my son Henry William Lamb absolutely.

2. I appoint my Nephew Charles Edward Lamb sole Executor of this my Will and I authorize him to charge for and to retain or be paid for out of my Estate for any professional duties connected therewith whether performed by himself or by others and also to retain reasonable remuneration for his own loss of time and trouble in connection therewith.

3. I devise the several classes pieces or parcels of copyhold Land situate within the Manor of Liddington with Baldecott in the County of Rutland to which as the surviving Mortgages thereof

19th December 1917

under a Mortgage from John Brown Ward and William Edward Ward in favour of the late William John Woolley and myself I was admitted Tenant on the Court Rolls of the said Manor on the sixth day of July one thousand nine hundred and three To Colonel William Stanford Baldock and Colonel Alfred Stowell Jones (to whom jointly with me the principal money secured by such Mortgage now belongs upon a joint account) or to the survivor of them if either should die in my lifetime.

4. And I revoke all former Wills and codicils made by me.

In witness whereof I have hereunto set my hand this fourth day of July One thousand nine hundred and eleven Geo. W.

Lamb & signed by the said George Warren Lamb as and for his Will in the presence of us both present at the same time who in his presence and in the presence of each other have hereunto subscribed our names as witnesses & Charles E. Whiteher Wilbury Avenue House Medical Practitioner - Henry W. Lamb Solicitor Solicitor Kettering.

Examined by me,

Richard Mills
Steward.

The Manor of Liddington
with Caldecott
in the County of Rutland

The Admission of William Stanford Baldock and Alfred Stowell Jones out of Court at Stamford on the nineteenth day of December one thousand nine hundred and seventeen Before

Richard Mills English Steward of the Courts of the Most Honorable William Thomas Brownlow Marquis of Exeter Baron of Burghley Lord of the said Manor

William Stanford Baldock and Alfred Stowell Jones as Devises of George Warren Lamb

Be it remembered that on the nineteenth day of December one thousand nine hundred and seventeen William Stanford Baldock of Wellington in the County of Somerset a Colonel (Retired) in the Royal Artillery and Alfred Stowell Jones of Finchampton in the County of Berks Civil Engineer by Fred Andrews their Attorney came before me Richard Mills English Steward of the Courts of this Manor and represented that George Warren Lamb late of

Admission to
Lamb & Co
2.11.18

19th December 1917

Wardley Somerhill Avenue House in the County of Sussex
 Gentleman died on the fifteenth day of January one thousand
 nine hundred and fifteen seized of divers hereditaments holden
 of this Manor and produced to me the Probate of the Will dated
 the fourth day of July one thousand nine hundred and eleven of
 the said George Warren Lamb which Will has been duly enrolled
 on the Court Rolls of the Manor and therein is contained the
 following devise "I devise the several closes pieces or parcels of
 copyhold land situate within the Manor of Liddington with
 Caldercott in the County of Rutland to which as the surviving
 Mortgages thereof under a Mortgage from John Brown Ward and
 William Edward Ward in favour of the late William John Woolley
 and myself I was admitted Tenant on the Court Rolls of the said
 Manor on the sixth day of July one thousand nine hundred and
 three to Colonel William Stamford Baldock and Colonel Alfred
 Howell Jones (to whom jointly with me the principal money secured
 by such Mortgage now belongs on a joint account) or to the survivor
 of them if either should die in my lifetime **Now** the said William
 Stamford Baldock and Alfred Howell Jones by their said Attorney
 come and pray to be admitted Tenants to All that close or parcel
 of land situated in Caldercott aforesaid within the said Manor
 called "Plough Close" containing six acres and nine perches or
 thereabouts bounded on the Northwest by the Road leading
 from Caldercott to Liddington on the Northeast by land belonging
 to the Ecclesiastical Commissioners on the South West by land
 now or late of Robert Lenton Ward and on the Southeast by the
 Rugby and Stamford line of the London and North Western
 Railway Company. **And also** all that other close or parcel of
 land situated at Caldercott aforesaid within the said Manor called
 "Top Pitch Furlong" containing seven acres two roods and thirty
 seven perches or thereabouts bounded on the Northwest by the
 said Rugby and Stamford line of Railway on the North east
 by land belonging to the said Ecclesiastical Commissioners on the
 Southwest by land now or late of James Saunders or part of the
 Southeast by land now or late of Hutchinson Hunt and on the
 remaining part of the Southeast by the land next hereinafter

19th December 1914.

described Which said two closes of land before described formerly formed part of a plot or parcel of land in the Middle field and Lower field containing twenty six acres one rood and nine perches. And also all that close or parcel of land situate at Baldecott aforesaid within the said Manor containing twenty acres two roods or thereabouts bounded on the Northwest by the lastly described close of land on the Northeast by land belonging to the said Ecclesiastical Commissioners on the Southwest by land belonging now or late to the said Hutchinson Hunt and on the Southeast by the next described close of land. Which said close of land included a portion of a plot of land which formerly formed part of the before mentioned parcel of land containing Twenty six acres, one rood and nine perches and the remaining portion thereof formerly formed part of another plot of land in the Lower field and low pasture containing thirty one acres one rood and one perch. And also all that close of land situate at Baldecott aforesaid within the said Manor containing forty one acres and thirty perches or thereabouts bounded on part of the Northwest by the lastly described close of land and on the remaining part of the Northwest by land belonging to the Ecclesiastical Commissioners on the Southwest by land now or late of the said Hutchinson Hunt and on all other parts by the River Welland - a portion of which close formerly formed part of the before mentioned parcel of land containing thirty one acres one rood and one perch and the remainder thereof comprised the whole of another plot of land in the low pasture containing two acres one rood and nineteen perches To the whole of which before described hereditaments the said George Warren Lamb deceased was admitted Tenant on the sixth day of July one thousand nine hundred and three upon the forfeited conditional Surrender of John Brown Ward dated the eighteenth day of April one thousand eight hundred and seventy nine under the several yearly rents of One shilling and three pence half penny, eleven pence farthing, one shilling and seven pence three farthings, two pence three farthings, One shilling and three pence half penny, eleven pence farthing, one shilling and seven pence three farthings two pence three farthings and one shilling and two pence, half penny and of which he so died seized and devised as aforesaid **Com John** the Lord by his said Steward granted seizin by the Rod **Co Hold** the

19th December 1917.

Rents

1.	3 ¹ / ₂
	11 ¹ / ₄
1.	7 ³ / ₄
	2 ³ / ₄
1.	3 ¹ / ₂
	11 ¹ / ₄
1.	7 ³ / ₄
	2 ³ / ₄
1.	10 ¹ / ₂
	10" 1

Fine p. life

	10" 1
2nd "	5" 0 ¹ / ₂

hereditaments aforesaid with the appurtenances unto the said William Stanford Baldoek and Alfred Stowell Jones and their heirs at the Will of the Lord according to the custom of the Manor by the rents suits and services therefor due and of right accustomed and they give to the Lord for Tines as in the margin are admitted Tenants and their fealty is respited.

Examined by me,
Richardusell
 Steward.

Involment of Will of Mary Ann Colwell

P. 8. 11. 17
James Colwell 17. 12. 17

I Mary Ann Colwell of Lyddington in the County of Rutland Widow declare this to be my last Will and Testament I appoint my sons John Edward Marwin and John Hugh Colwell to be the Executors of this my Will. I give my Pianoforte to my daughter Mary Ellen Richmond I give all my plate plated articles linen china glass crockery and knives and forks to my daughters Annie Elizabeth Colwell and Edith Ethel Colwell equally to be divided between them. And I also give and devise my messuage or dwellinghouse situate at Lyddington aforesaid in which I now reside with the yard garden orchard and appurtenances thereto to my said daughters Annie Elizabeth Colwell and Edith Ethel Colwell as tenants in common in equal shares. I give all the residue of my property whatsoever and wheresoever to my said daughters Mary Ellen Richmond Annie Elizabeth Colwell Edith Ethel Colwell and my daughter Helena Margaret Richmond in equal shares. In witness whereof I have set my hand to this my Will the eighteenth day of November one thousand nine hundred and eleven M. A. Colwell is signed by the above named Mary Ann Colwell as her last Will in the presence of us both being present at the same time who in her presence and in the presence of each other have hereunto subscribed our names as Witnesses - F. E. Hodgkinson, Solicitor, Uppingham, G. Dawson Lyddington, Motor Driver.

Examined by me,
Richardusell
 Steward.

31st December 1917.

The Manor of Liddington

with baldecott
in the county of Rutland

The Admission

of Annie Elizabeth Colwell and Edith ~~Colwell~~^{Edith} Colwell out of court at Stamford on the thirtyfirst day of December one thousand nine hundred and seventeen Before Richard Mills English Steward of the courts of the Most Honorable William Thomas Brownlow Marquis of Exeter Baron of Burghley Lord of the said Manor

Annie Elizabeth Colwell
and Edith ~~Colwell~~^{Edith} Colwell
devises of Mary Ann
Colwell.

Be it remembered

that on the thirty first day of December one thousand nine hundred and seventeen Annie Elizabeth Colwell and Edith ~~Colwell~~^{Edith} Colwell both of Liddington in the county of Rutland spinsters came before me Richard Mills English Steward of the courts of this Manor and represented that Mary Ann Colwell late of Liddington aforesaid died on the eighth day of December one thousand nine hundred and eleven seized of All that messuage or Tenement with the yards garden, Orchard, Stables and outbuildings thereto belonging at Liddington within and holden of the said Manor late in the occupation of the said Mary Ann Colwell and to which she was admitted tenant on the twenty fourth day of June one thousand eight hundred and eighty as devises of Hugh Clarke deceased under the yearly rent of one shilling and sixpence. And it is also represented to me that the said Mary Ann Colwell by her Will dated the eighteenth day of November one thousand nine hundred and eleven (which has been duly enrolled on the Court Rolls of this Manor and of which Probate was granted in the District Probate Court at Leicester on the seventeenth day of December one thousand nine hundred and twelve) devised as follows: "I also give and devise my messuage or dwelling house situate at Liddington aforesaid in which I now reside with the yard garden Orchard and appurtenances thereto to my said daughters Annie Elizabeth Colwell and Edith ~~Colwell~~^{Edith} Colwell as tenants in common in equal shares." **Now** the said Annie Elizabeth Colwell and Edith ~~Colwell~~^{Edith} Colwell come and pray to be admitted to the hereditaments aforesaid of which the said Mary Ann Colwell so died seized and devised as

*Admission to the Manor
9.12.17*

4th February 1918.

aforesaid. **To whom** the Lord by his said Steward granted seizin by the Rod **To hold** the hereditaments aforesaid with the appurtenances unto the said Annie Elizabeth Colwell and Edith ~~Colwell~~ ^{Colwell} Colwell and their heirs as tenants in common at the Will of the Lord according to the custom of the Manor by the rents suits and services therefore due and of right accustomed and they severally give to the Lord for Fines as in the margin are admitted Tenants and their fealty is respited.

Fine 9^d
Rent 9^d
Fine 9^d
Rent 9^d

Examined by me,

Richard Mills
Steward.

Involvement of Will of Thomas Middleton.

This is the Last Will and Testament of me Thomas Middleton of Lyddington in the County of Rutland, Farmer. I appoint my Wife Martha Middleton the Executrix of this my Will I devise and bequeath all my property whatsoever and wheresoever unto my said Wife absolutely. I revoke all former Wills and testamentary dispositions made by me and declare this to be my last Will. In witness whereof I have hereunto set my hand this twenty sixth day of May one thousand nine hundred and five - T. Middleton - Signed by the said Thomas Middleton the testator in our presence and by us in his presence Charles Atter, Stamford Solicitor - Allan Wm. Rippon, his Clerk.

Examined by me,

Richard Mills
Steward.

The Manor of Lyddington

with Caldercott

in the County of Rutland

The Commission of Martha Middleton

out of Court at Stamford on the fourth day of February one thousand nine hundred and eighteen

Before Richard Mills English Steward of the Courts of the Most Honorable William Thomas Browlow Marquis of Exeter Baron of Bughley Lord of the said Manor,

4th February 1918.

Martha Middleton
Devises of
Thomas Middleton

Admors Co. M. H. H. H. H. H.
8-2-18

Be it remembered that on the fourth day of February One thousand nine hundred and eighteen Martha Middleton of no Liddington in the county of Rutland Widow by Fred Andrews her Attorney came before me Richard Mills English Steward of the courts of this Manor and represented that Thomas Middleton late of Liddington aforesaid Farmer a copyhold Tenant of the Manor died on the nineteenth day of November One thousand nine hundred and seventeen seized of All that messuage ~~now~~ situated at Liddington aforesaid within and holden of the Manor with the garden and Orchard thereunto belonging late in the occupation of the said Thomas Middleton and now of the said Martha Middleton to which hereditaments the said Thomas Middleton deceased was admitted tenant on the eighteenth day of June One thousand eight hundred and sixty three on the surrender of Thomas William Gilham under the yearly rent of six pence And it is also represented to me that the said Thomas Middleton by his Will dated the twenty sixth day of May one thousand nine hundred and five and proved in the District Probate Registry at Leicester on the thirtieth day of January one thousand, nine hundred and eighteen which has been produced to me and duly enrolled on the court Rolls of the Manor devised and bequeathed all his property whatsoever and wheresoever unto his Wife the said Martha Middleton absolutely **Now** the said Martha Middleton by her said Attorney came and prayed to be admitted to the hereditaments aforesaid of which the said Thomas Middleton so died seized and devised as aforesaid **To whom** the lord by his said Steward granted seizin by the Rod **To hold** the hereditaments aforesaid with the appurtenances unto the said Martha Middleton and her heirs at the Will of the lord according to the custom of the Manor by the rents suits and services therefor due and of right accustomed and she gives to the lord for a Fine as in the margin is admitted Tenant and her Fealty is respited.

<u>Rent</u>	d
	6
<u>Fine</u>	d.
	6

Examined by me,
Richard Mills
Steward

25th February 1918.

Extract

Stamp 10/-

from an Indenture dated the nineteenth day of February one thousand nine hundred and eighteen made between Verden Henry Bettinson of Watermeaton in the county of Huntingdon Farmer and Grazier (hereinafter called "the Trustee") of the first part Stanley Edmund Ward a Private in the Army Service Corps stationed at Beckenham in the county of Kent (hereinafter called "the heir at law") of the second part William Stanford Baldoek late of Sunnycroft but then of Foxdown Wellington in the county of Somerset a Lieutenant Colonel on the retired list late Royal Artillery and Alfred Howell Jones V. C. of Ridge Cottage Finchampstead in the county of Berks Civil Engineer (hereinafter called "the Mortgagees") of the third part and George William Johnson of Tur Langton in the county of Leicester Farmer and Grazier (hereinafter called "the Purchaser") of the fourth part.

" And the Mortgagees hereby appoint the Trustee their
" Attorney in their name and on their behalf and as their
" act and deed to surrender the said hereditaments, and
" premises into the hands of the Lord of the said Manor. To
" the use of the purchaser his heirs and assigns according to
" the custom of the said Manor as aforesaid they hereby agreeing
" to allow and confirm all that their said Attorney shall do
" or cause to be done by virtue of this power and they declare
" that this power of Attorney is irrevocable by them for one
" year from the date hereof.

Examined by me,
Chamberlain
Steward.

The Mayor of Liddington

with Caldercott
in the county of Rutland

Be it remembered that on the twenty fifth day of February one thousand nine hundred and eighteen William Stanford Baldoek late of Sunnycroft but now of Foxdown Wellington in the county of Somerset a Lieutenant Colonel on the retired list late Royal Artillery and Alfred Howell Jones V. C. of Ridge Cottage Finchampstead in the county of Berks. Civil Engineer (hereinafter called "the Surrenderors") copy-

Messrs Wm S. Baldoek
and Alfred S. Jones

to
Mr. George W. Johnson

Absolute Surrender

Stamp 2/34

25th February 1918.

hold tenants of the said Manor by Verden Henry Bettinson, their
 Attorney came before me Richard Mills English Steward of the said
 Manor out of Court in consideration of Three thousand four hundred
 pounds to them paid by George William Johnson of Fur Langton
 in the County of Leicester Farmer and Grazier (the receipt whereof is
 hereby acknowledged) and in pursuance of a covenant in that
 behalf contained in an Indenture dated the nineteenth day of
 February one thousand nine hundred and eighteen and made
 between the said Verden Henry Bettinson of the first part, Stanley
 Edmund Ward of the second part the Surrenderors of the third part
 and George William Johnson of the fourth part Did surrender out of
 their and each of their hands into the hand of the Lord of the said
 Manor by the hands and acceptance of the said Steward by the rod
 according to the custom of the said Manor All that close or parcel of
 land situated at Baldecott in the County of Rutland within the said
 Manor formerly called Ploughclose but now known as Foot Road close
 formerly stated to contain six acres and nine perches, but by the Ordnance
 Survey measurement stated to contain six acres and two perches bounded
 on the Northwest by the Road leading from Baldecott to Liddington on the
 Northeast by land belonging to the Ecclesiastical Commissioners on the
 Southwest by land formerly belonging to Robert Lenton Ward and now
 to the Representatives of Dalby Langley and on the South East by the Rugby
 and Stamford Line of the London and North Western Railway. And
 also all that close or parcel of land situate at Baldecott aforesaid called
 Top pitch Furlong formerly stated to contain seven acres two roods and
 thirty seven perches or thereabouts but by Ordnance Survey measurement
 seven acres three roods and thirty five perches bounded on the Northwest
 by the said Rugby and Stamford Line of Railway on the Northeast by land
 belonging to the said Ecclesiastical Commissioners on the South west by
 land formerly belonging to James Sanders and now to William Thomas
 Hays on part of the Southeast by land belonging to the Representatives of
 of Hutchinson Dalby Hunt and on the remaining part of the Southeast
 by the land next hereinafter described And also all that close or parcel
 of land situate at Baldecott aforesaid formerly stated to contain Twenty
 acres and two roods or thereabouts but by Ordnance Survey measurement
 Twenty acres one rood and eighteen perches bounded on the Northwest

25th February 1918

by the close or parcel of land lastly hereinbefore described, on the North East by land belonging to the Ecclesiastical Commissioners on the South West by land belonging to the Representatives of the said Hutchinson Dalby Trust and on the South East by the close or parcel of land next hereinafter described. And also all that other close or parcel of land situate at Caldercott aforesaid formerly stated to contain Forty one acres and thirty perches or thereabouts but which has since been divided into and now forms three closes of land containing by Ordnance Survey measurement and known by the respective names following namely Near Bottom close containing eighteen acres two roods and thirty three perches Far Bottom close four acres two roods and thirty five perches and Meadow sixteen acres three roods and six perches. All which said closes or parcels of land were formerly in the occupation of John Brown and are now unoccupied and are on the Ordnance Survey map for the Parish of Caldercott numbered respectively 75, 73, 74, 20, 26 and 23 and contain in the whole (with the site of the River three roods and twenty six perches or thereabouts) seventy five acres one rood and thirty five perches or thereabouts to which said closes of land the Surrenders were admitted on the nineteenth day of December one thousand nine hundred and seventeen To the use of the said George William Johnson his heirs and assigns for ever at the Will of the Lord according to the custom of the said Manor by and under the rents fines heriots suits and services due and of right accustomed for the same - V. H. Bettinson - Taken and surrendered the day and year first above written By and before me - Richd. M. English, Steward

Examined by me,

Richard M. English
Steward.

25th February 1918.

The Manor of Liddingtonwith baldecott
in the bounty of Rutland**The Admission** of George WilliamJohnson out of court at Stamford, on the
twenty fifth day of February one thousand nine
hundred and eighteen Before Richard Mills English Steward of the
Courts of the Most Honorable William Thomas Brownlow Marquis
of Exeter Baron of Burghley Lord of the said Manor.George William
Johnson on Surrender
of William Stamford
Baldoek and Alfred
Stowell Jones.

Be it remembered that on the twenty fifth day of February
one thousand nine hundred and eighteen George William
Johnson of Fox Langton in the bounty of Leicester Farmer and
Grazier by Henry Burgess his Attorney came before Richard Mills
English Steward of the Courts of the said Manor and prayed to be
admitted Tenant to All that close or parcel of land situated at
baldecott within the said Manor formerly called Plough close but
now known as Foot road close formerly stated to contain six acres
and nine perches but by the Ordnance Survey measurement stated
to contain six acres and two perches bounded on the Northwest by the
Road leading from baldecott to Liddington on the Northeast by land
belonging to the Ecclesiastical Commissioners on the Southwest by
land formerly belonging to Robert Lenton Ward and now to the
Representatives of Bathy Langley and on the South east by the Rugby
and Stamford line of the London and North Western Railway.
And also all that close or parcel of land situated at baldecott
aforesaid called Top Pitch Furlong formerly stated to contain seven
acres two rods and thirty seven perches or thereabouts but by Ordnance
Survey measurement seven acres three rods and thirty five perches
bounded on the Northwest by the said Rugby and Stamford line of
Railway on the Northeast by land belonging to the said Ecclesiastical
Commissioners on the Southwest by land formerly belonging to
James Sanders and now to William Thomas Hay on part of the
Southeast by land belonging to the Representatives of Hutchinson
Dalby Hunt and on the remaining part of the South east by the
land next hereinafter described And also all that close or parcel
of land situated at baldecott aforesaid formerly stated to contain
Twenty acres and two rods or thereabouts but by Ordnance Survey

Admission to
Rugby and Stamford
4/2/18

25th February 1918.

Measurement, twenty acres, one rood and eighteen perches bounded on the North-west by the close or parcel of land lastly hereinbefore described on the North-east by land belonging to the Ecclesiastical Commissioners on the South-west by land belonging to the Representatives of the said Hutchinson Dalby Hunt and on the South East by the close or parcel of land next hereinafter described And also all that other close or parcel of land situated at Baldecote aforesaid formerly stated to contain Forty one acres and thirty perches or thereabouts but which has since been divided into and now forms three closes of land containing by Ordnance Survey measurement and known by the respective names following namely Near Bottom close containing Eighteen acres two roods and thirty three perches Far Bottom close Four acres two roods and thirty five perches and Meadow sixteen acres three roods and six perches All which said closes or parcels of land were formerly in the occupation of John Brown and are now unoccupied and are on the Ordnance Survey Map for the Parish of Baldecote numbered respectively 75, 73, 71, 28, 26 and 23 and contain in the whole (with the site of the River three roods and twenty six perches or thereabouts) seventy five acres, one rood and thirty five perches or thereabouts. To which hereditaments William Stanford Baldoke and Alfred Stowell Jones were admitted Tenants on the nineteenth day of December One thousand nine hundred and seventeen under the several yearly rents of ten shillings and one penny and which were by them this day surrendered to the use of the said George William Johnson his heirs and assigns at the Will of the Lord according to the custom of the Manor Compton the Lord by his said Steward granted seizin by the Rod. Co Hold the hereditaments aforesaid with their appurtenances unto the said George William Johnson his heirs and assigns at the Will of the Lord according to the custom of the Manor by the rents suits and services therefor due and of right accustomed and he gives to the Lord for a Fine as in the margin is admitted Tenant and his fealty is respited.

This number bears a
Stamp of thirty four pounds
Rents *Milnesfeld*
10 1

1 "	3 1/2
	11 1/4
1 "	4 3/4
	2 3/4
1 "	3 1/2
	11 1/4
1 "	4 3/4
	2 3/4
1 "	10 1/2
<hr/>	
	10 1
<hr/>	
<u>Fine</u>	10. 1

Examined by me,
Milnesfeld
Steward.

6th May 1918.

The Most Honorable
The Marquis of Exeter
to
Mr George Taylor

Deed of
Enfranchisement

Stamp
1/-

See sent to Mr. Decker
8 May 18.

This Indenture made the sixth day of May One thousand nine hundred and eighteen Between The Most Honorable William Thomas Brownlow Marquis of Exeter Baron of Broughley (hereinafter called "the Marquis") of the one part and George Taylor of Stoke Dry in the County of Rutland Gentleman of the other part. Whereas the Marquis is seized in fee simple of the Manor of Liddington with Baldecott in the County of Rutland. And whereas on the twenty fourth day of November One thousand nine hundred and thirteen the said George Taylor was admitted Tenant to the hereditaments and premises hereinafter described upon the surrender of Thomas William Wright and Francis Kelham Wright. And whereas the Marquis has agreed with the said George Taylor for the Enfranchisement of the said hereditaments for the sum of seven pounds ten shillings and eight pence Now this Indenture witnesseth that in consideration of seven pounds ten shillings and eight pence to the Marquis paid by the said George Taylor on or before the execution of these presents (the receipt whereof the Marquis doth hereby acknowledge) the Marquis as Beneficial owner doth hereby enfranchise and convey to the said George Taylor All that close piece or parcel of land known as "the Top Brand" formerly described as containing four acres or thereabouts but by recent Government survey found to contain three acres one rood and eighteen perches or thereabouts situated on the Brand in Liddington aforesaid. And also all that close piece or parcel of land known as "the Bottom Brand" formerly described as containing two acres two roods or thereabouts but by recent Government survey found to contain two acres three roods and twenty perches or thereabouts situated lying and being on the Brand in Liddington aforesaid. Which hereditaments were formerly in the occupation of Thomas Ernest Middleton and then of George Bryan. Together with the appurtenances excepting the rights reserved by the Copyhold Act 1894 section 23. To hold the same as Freehold free and discharged from all rents fines suits and services and other incidents of Copyhold tenure except as aforesaid. Unto and to the use of the said George Taylor in fee simple. And it is certified that the transaction hereby effected does not form part of a larger transaction or of a series of transactions

in respect of which the amount or value or the aggregate amount or value of the consideration exceeds Five hundred pounds. In witness whereof the ~~Examined by me~~ said parties to these presents have hereunto set their hands and seals the day and year first above written - Exeter - ~~Steward~~ I signed sealed and delivered by the above named William Thomas Brownlow Marquis of Exeter in the presence of Geo. H. Mutter, Burghley Office, Stamford Land Agent.

Examined by me,
Steward
 Steward.

Extract from the last
 Will and Testament of
 Edwin Berkeley Cook

This is the last Will and Testament of me Edwin Berkeley Cook of Roydon Hall Tonbridge in the County of Kent a Lieutenant Colonel in His Majesty's Army I hereby revoke all Wills and Testamentary dispositions by me at any time heretofore made. I appoint my Brother Ralph Montague Cook my Sister Augusta Blanche Sansonby and Clement Upperton of 14 Lincoln Inn Fields in the County of London Esquire Executors and Original Trustees of my Will. I devise all my Estates and hereditaments of copyhold or customary tenure situate at Hyddington in the County of Rutland or elsewhere in the same County To such uses upon such trusts and subject to such powers and provisions as my Trustees shall during the lifetime of my said Original Trustee or the survivor of them or within twenty one years after the death of such survivor by any deed or deeds appoint for the purpose of carrying into effect any sale or disposition in pursuance of the trust hereinafter contained."

The Real Estate is subject to the trusts declared by the Will

Steward
 Steward.

Edwin died 4 Nov. 1914
 probate in principal Registry
 19 Dec. 1914

Involment of Will of
Abigail Parker

Dec 15 1913
prob. paid by
to Richards
James Richards
29 May 18

This is the Last Will and Testament of me
Abigail Parker of the Gables Lyddington in the County of Rutland
Widow. I appoint Lewis Richards of Kettering Ironmonger and
my Niece Sylvia Annie Middleton of the Gables Lyddington
aforesaid Executors and Trustees thereof. And I give to the said
Lewis Richards as an acknowledgment of the trouble he will be put
to the sum of Five pounds. I give to my Niece Gertrude Emily
Nicholls the sum of Fifty pounds. I give to John Parker, George
Parker and James Parker sons of Stephen Parker my late husband's
Brother the sum of Ten pounds each. I give to my said Niece Sylvia
Annie Middleton my freehold house garden and land at Lyddington
aforesaid and all other my property of every description for her own
absolute use and benefit subject to the payment of my debts funeral
and testamentary expenses (which I direct to be paid out of my personal
estate) and I revoke all former Wills. In witness whereof I have
to this my Will set my hand this first day of April 1913. Abigail
Parker - Signed by the above named Abigail Parker as her last
Will in the presence of us both being present at the same time who
in her presence and in the presence of each other have hereunto
subscribed our names as witnesses - Charles W. Lane, Solicitor
Kettering - Gilbert L. Lewis, Clerk to Messrs. Lane & Son
Solicitors Kettering.

Examined by me,

Rowland
Steward.

15th July 1918.

The Trustees of the Will
of the late Lieut. Col.
Edwin B. Cook M.V.O.
to
Mr. Edward Tyler
conveyance and
Bargain and Sale

This Indenture made the fifteenth day of July, One thousand nine hundred and eighteen. Between Ralph Montague book of Roydon Hall Tonbridge in the County of Kent Esquire and Augusta Blanche Ponsonby the Wife of Colonel Justinian Gordon Ponsonby of Villa Sorrento Dinard France (hereinafter called "the Vendors") of the one part and Edward Tyler of Moreott in the County of Rutland Farmer (hereinafter called "the Purchaser") of the other part. Whereas Edwin Berkeley book late of Roydon Hall Tonbridge aforesaid a Lieutenant Colonel 1st Life Guards M.V.O. deceased being seized in fee simple in possession free from incumbrances of the freehold hereditaments hereinafter described and being also seized of the copyhold hereditaments hereinafter described for an estate of inheritance in possession free from incumbrances according to the custom of the Manor of Lyddington with Calderott in the said County of Rutland subject to the rents suits and services therefor due and of right accustomed duly made his Will dated the tenth day of March one thousand nine hundred and fourteen and thereby appointed the Vendors and Clement Upperton of 14 Lincoln's Inn Fields London executors and original trustees thereof and declared that the expression his Trustees when used in his Will should mean his said original Trustees or the survivors or survivor of them or the executors or administrators of such survivor or other Trustees or Trustee for the time being of his Will and (inter alia) devised all his estates and hereditaments of copyhold or customary tenure situate at Lyddington in the County of Rutland or elsewhere in the same County To such uses upon such trusts and subject to such powers and provisions as his Trustees should during the lifetime of his said original Trustees or the survivor of them or within twentyone years after the death of such survivor by any deed or deeds appoint for the purpose of carrying into effect any sale or disposition in pursuance of the trust therein after contained. And Testator devised all his real estate of every tenure including chattels real situate at Lyddington aforesaid or elsewhere in the County of Rutland but as to copyhold or customary hereditaments in default of and subject to any appointment under the power therein before contained Unto and to the use of his said original Trustees their heirs executors or administrators according to the nature thereof Upon

Sep.
£44.10.0
I.V.D. 177-18

15th July 1918.

trust that his trustees should sell his said estate at such time or times
 and in such manner as they should think fit and so that they should
 have the fullest power to postpone the sale of the whole or any part or
 parts of the said estate so long as they should think proper and without
 being liable for consequential loss and should hold the moneys to
 arise from such sale upon the trusts therein mentioned. And whereas
 the said Testator made two Codicils to his said Will both dated
 the tenth day of August One thousand nine hundred and fourteen
 neither of which affected the appointment of Executors and Trustees
 made by or the devise of his freehold and copyhold property at Lyddington
 aforesaid contained in his said Will. And whereas the said testator
 died on the fourth day of November One thousand nine hundred and
 fourteen without having altered or revoked his said Will so far as the
 same is hereinbefore recited and the said Will and Codicils were
 on the nineteenth day of December one thousand nine hundred and
 fourteen duly proved by the said executors in the Principal Registry
 of the High Court of Justice. And whereas the said Clement Waperton
 died on the twelfth day of April one thousand nine hundred, and
 eighteen. And whereas in exercise of the trust for that purpose
 contained in the said Will the Vendors have agreed to sell the freehold
 and copyhold hereditaments hereinafter described to the Purchaser
 at the price of Four thousand four hundred and fifty pounds. Now
 this Indenture witnesseth that in consideration of the sum of
 Four thousand four hundred and fifty pounds to the Vendors paid
 by the Purchaser on or before the execution of these presents (the receipt
 whereof the Vendors hereby acknowledge) the Vendors as such trustees
 as aforesaid and in pursuance of the trust for sale contained in the said
 Will hereby convey unto the Purchaser All that plot piece or parcel
 of pasture land situate lying and being in the Netherfield in Lyddington
 aforesaid containing thirteen acres two roods and thirty four perches
 more or less bounded on or towards the East by the Gretton Road, on
 or towards the North by the copyhold parcels of land containing
 respectively sixteen acres three roods and two acres and three roods
 hereinafter respectively described on or towards the West by the
 copyhold land called Garbage Slade also hereinafter described and on
 the South by an allotment to Robert Walker now the Estate of Messrs.

The Ecclesiastical Commissioners. The Rev. Hugh Bryan

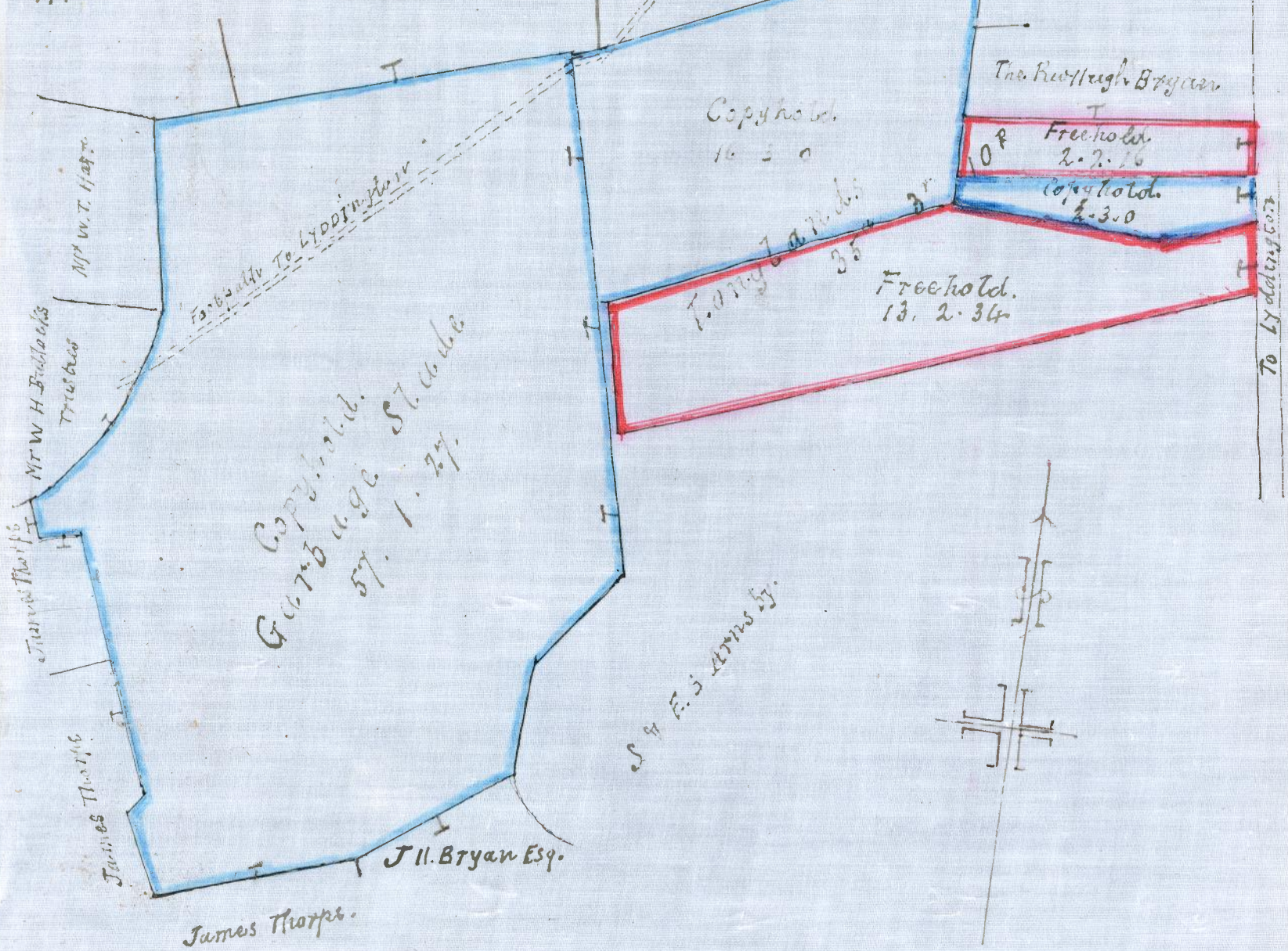

Copyhold. 6. 7. 6. 9. 57. 1. 2. 27.

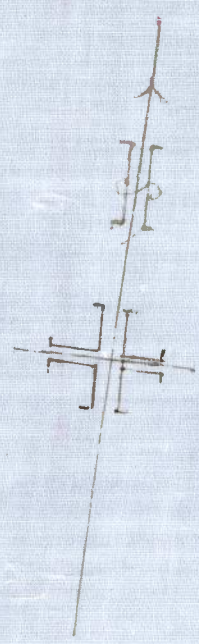

15th. July 1918.

Samuel Amsby and Edward Sewell Amsby and which plot piece or parcel of land now being described is the freehold portion of a parcel of land called Longlands and the same was awarded in the Enclosure of Lyddington with Baldecott and Uppingham to Thomas Bryan. Also all that plot piece or parcel of land situate lying and being in the Netherfield in Lyddington aforesaid containing two acres two roods and sixteen perches more or less bounded on or towards the East by the Gretton Road on or towards the North by an Allotment to Edward Marvins now belonging to the Reverend Hugh Bryan on or towards the West by the copyhold parcel of land containing sixteen acres and three roods hereinafter described and on or towards the South by the copyhold parcel of land containing two acres and three roods also hereinafter described and which plot piece or parcel of land now being described was formerly in two parcels containing one acre one rood and ten perches and one acre one rood and six perches respectively and which said parcels were the property of Thomas Manton and Robert Sliffe by whom the same were sold and conveyed to Thomas John Bryan. All of which said plots pieces or parcels of land are delineated in the plan endorsed hereon and are thereon edged with a Pink colour. To hold the same unto and to the use of the Purchaser in fee simple. And this Indenture also witnesseth that for the consideration aforesaid the Vendors as such Trustees as aforesaid and in further pursuance of the trust for sale contained in the said Will of the said Edwin Berkeley book as aforesaid and of all other powers if any therein hereunto enabling do hereby bargain sell and appoint unto the Purchaser All the copyhold hereditaments hereinafter described held of the Manor of Lyddington with Baldecott in the said County of Rutland namely All that plot piece or parcel of land situate lying and being in Lyddington aforesaid containing two acres and three roods more or less bounded on or towards the East by the Gretton Road on or towards the North by the freehold parcel of land containing two acres two roods and sixteen perches hereinafter described on or towards the West by the parcel of land containing sixteen acres and three roods hereinafter described and on the South by the freehold parcel of land containing thirteen acres

15th July 1918.

two roods and thirty four perches hereinbefore described And which plot piece or parcel of land now being described was formerly in two parcels containing one acre one rood and fourteen perches and one acre one rood and twenty six perches respectively and which said parcels were the property of Thomas Manton and Robert Iliffe by whom the same were sold to the said Thomas John Bryan and to which the said Thomas John Bryan was admitted at a Court held in and for the said Manor on the twenty eighth day of April One thousand eight hundred and twenty five. Also all that plot piece or parcel of land situate lying and being in Lyddington aforesaid containing sixteen acres and three roods more or less bounded on or towards the East by land of the said Reverend Hugh Bryan and the freehold parcel containing two acres two roods and sixteen perches and the copyhold parcel of land containing two acres and three roods hereinbefore respectively described on or towards the North by the estate of the said Reverend Hugh Bryan or or towards the West by the parcel of land called Garbage Slade herein after described and on the South by the freehold parcel of land containing thirteen acres two roods and thirty four perches hereinbefore described And also all that close piece or parcel of land situate lying and being in Lyddington aforesaid called or known by the name of Garbage Slade containing by admeasurement fifty seven acres one rood and twenty seven perches (more or less) bounded on or towards the North by land of the Ecclesiastical Commissioners for England and Wales on or towards the West by land of William Thomas Hayr the Trustees of William Henry Bullock and James Thorpe respectively on or towards the south by land of the said James Thorpe and a close of land called the Hills belonging to John Henry Bryan And on or towards the East by an Allotment to Robert Walker now the property of the said Samuel Anshy and Edward Serrell Anshy the freehold parcel of land containing thirteen acres two roods and thirty four perches and the copyhold parcel of land containing sixteen acres and three roods hereinbefore respectively described and which said three last described parcels of land were formerly portion of an allotment containing One hundred and twenty eight acres and one rood awarded on the Enclosure of Lyddington with Baldeoth and

15th July 1918.

Uppingham aforesaid to the said Thomas Bryan and all of which said copyhold plots of land are delineated in the said plan and are therein edged with a blue colour. And the entirety of which freehold hereditaments hereinbefore conveyed or expressed or intended so to be and the said copyhold hereditaments are now better known by the description of All that close of land part freehold and part copyhold of the said Manor situate in the Parish Lordship or Liberties of Liddington aforesaid containing in the aggregate thirty-five acres three roods and ten perches (by a recent admeasurement) and called or known by the name of Longlands bounded on the West by the said close of land called Garbage Slade on the South by the said land now belonging to the said Samuel Annsby and Edward Sewell Annsby on the North and part of the East by land of the said Reverend Hugh Bryan and on the remaining part of the East by the Road leading from Liddington to Gretton and the same is now in the occupation of the Purchaser. And also all that the said close of land called Garbage Slade formerly said to contain sixty acres or thereabouts but by recent survey found to contain only Fifty seven acres one rood and twenty seven perches bounded on part of the East by the said close of land called Longlands and on the remaining part of the East and on all other parts as before set out and the same is now in the occupation of the Purchaser and is edged with a blue colour on the said plan. Together with all and singular the rights members and appurtenances belonging or therewith appertaining. To hold all the said copyhold hereditaments Unto and to the use of the Purchaser in customary fee simple according to the custom of the said Manor by and under the rents fines suits and services therefor due and of right accustomed. In witness whereof the said parties hereto have hereunto set their hands and seals the day and year first above written - Ralph M. Cook ^(S) Augusta Blanche Ponsonby ^(S) Signed sealed and delivered by the said Ralph Montague Cook in the presence of Lewis P. Haynes, Boroughs Oak, ^{Kent} Peckham Kent Agent. Signed sealed and delivered by the above named Augusta Blanche Ponsonby in the presence of Maria J. Cooper, 626 Chury Street London Wife of William Cooper, Householder.

Examined by me,



Steward.

23rd July 1918.

The Manor of Liddington

with Caldecott

in the County of Rutland

The Admission of Edward Tyler

out of Court at Stamford on the twenty third day of July one thousand nine hundred, and eighteen Before Richard Mills English Steward of the Courts of the Most Honorable William Thomas Browlow Marquis of Exeter Baron of Bughley Lord of the said Manor.

Edward Tyler under Bargain and Sale from Ralph Montague book and Augusta Blanche Pousonby.

Whereas

by an Indenture dated the fifteenth day of July, One thousand nine hundred and eighteen made between Ralph Montague book of Roydon Hall Tonbridge in the County of Kent Esquire, and Augusta Blanche Pousonby the Wife of Colonel Justinian Gordon Pousonby of Villa Sorrento Dinard France of the one part and Edward Tyler of Morcott in the County of Rutland Farmer of the other part the said Ralph Montague book and Augusta Blanche Pousonby have in pursuance of a power for that purpose contained in the Will of Edwin Berkeley book late of Roydon Hall aforesaid a Lieutenant Colonel first life Guards a copyhold tenant of the Manor which Will is dated the tenth day of March one thousand nine hundred and fourteen, and has been duly entered on the Court Rolls, bargained sold and appointed the hereditaments hereinafter described To the use of the said Edward Tyler in customary fee simple according to the custom of the said Manor by and under the rents fines suits and services therefor due and of right accustomed. **Now** be it remembered that on the twenty third day of July One thousand nine hundred and eighteen the said Edward Tyler by Fred Andrews his Attorney came before Richard Mills English Steward of the Courts of the said Manor and produced the said Bargain and Sale which he prayed might be enrolled on the Court Rolls of the Manor and the same has been enrolled accordingly and also prayed that he might be admitted Tenant to the hereditaments so bargained sold and appointed to him as aforesaid (namely) all that plot piece or parcel of land situate lying and being in Liddington, aforesaid containing two acres and three roods more or less bounded on or towards the East by the Bretton Road or or towards the North by a freehold parcel of land containing two acres two roods and sixteen perches or or towards the West by a parcel of land containing sixteen acres

Seeing that this Bargain & Sale bears a Stamp of Forty four pence the said

Richard Mills
Steward

Admission Co. to
Mr. Montague
30.7.18

2. 3rd July 1718.

and three roods hereinafter described and on the South by a freehold parcel of land containing thirteen acres two roods and thirty four perches. And which plot piece or parcel of land now being described was formerly in two parcels containing one acre one rood and fourteen perches and one acre one rood and twenty six perches. ^{particulars} Also all that plot piece or parcel of land situate lying and being in Liddington aforesaid containing sixteen acres and three roods more or less bounded on or towards the East by land of the Reverend Hugh Bryan and the freehold parcel containing two acres two roods and sixteen perches and the copyhold parcel of land containing two acres and three roods hereinbefore respectively described on or towards the North by the estate of the said Reverend Hugh Bryan or or towards the West by the parcel of land called Garbage Slade, hereinafter described and on the South by the freehold parcel of land containing thirteen acres two roods and thirty four perches. And also all that close piece or parcel of land situate lying and being in Liddington aforesaid called or known by the name of Garbage Slade containing by admeasurement fifty seven acres one rood and twenty seven perches more or less bounded on or towards the North by land of the Ecclesiastical Commissioners for England and Wales, on or towards the West by land of William Thomas Hays the Trustees of William Henry Bullock and James Thorpe respectively on or towards the South by land of the said James Thorpe and a close of land called the Hills belonging to John Henry Bryan. And on or towards the East by an allotment to Robert Walker now the property of Samuel Annsby and Edward Sewell Annsby the freehold parcel of land containing thirteen acres two roods and thirty four perches and the copyhold parcel of land containing sixteen acres and three roods hereinbefore described and which said three last described parcels of land were formerly portion of an allotment containing one hundred and twenty eight acres and one rood awarded on the Enclosure of Liddington with Calderott and Uppingham aforesaid to Thomas Bryan. Which hereditaments are now better known by the description of All that close of land part freehold and part copyhold of the said Manor situate in the Parish Lordship or Liberties of Liddington aforesaid containing in the aggregate thirty five acres three roods and ten perches (by a recent admeasurement) and called

Ren

Fin

23rd. July 1718.

or known by the name of Longlands bounded on the West by the said close of land called Garbage Slade on the South by land belonging to the said Samuel Arnsby and Edward Serrell Arnsby on the North and part of the East by land of the said Reverend Hugh Bryan and on the remaining part of the East by the road leading from Diddington to Gretton. And also all that the said close of land called Garbage Slade formerly said to contain sixty acres or thereabouts but by recent survey found to contain only fifty seven acres one rood and twenty seven perches bounded on part of the East by the said close of land called Longlands and on the remaining part of the East and on all other parts as before set out and are now in the occupation of the said Edward Tyler Together with all and singular the rights members and appurtenances belonging or therewith appertaining. To which hereditaments the said Edwin Berkeley took deceased was admitted Tenant on the sixteenth day of April one thousand eight hundred and ninety five on the Surrender of Francis Cook and others under several yearly rents amounting in the whole to one pound three shillings and two pence three farthings Common the Lord by his said Steward granted seizin by the Rod. Common the hereditaments aforesaid together with the appurtenances unto the said Edward Tyler and his heirs at the Will of the Lord according to the custom of the Manor by the Rents suits and services therefor due and of right accustomed and he gives to the Lord for a Fine as in the margin is admitted Tenant and his fealty is respited.

Examined by me,
Robert Berkeley
 Steward.

Rents.

6. 0
 10 1/2
 8
 6
 1. 1 1/2
 1. 10
 1. 1
 1. 1 1/2
 1. 1 1/2
 1. 1 1/2
 10 1/2
 5 3/4
 11 1/2
 2. 2 1/2
 2. 1 1/4
 2. 2 1/2
 3
 3
 5 1/4

£ 1⁰ 3² 3/4

Fine.

£ 1⁰ 3² 3/4

17th September 1918.

The Manor of Diddington

with Calderott

in the County of Rutland

The Submission of John

Ougden Ward out of Court at

Harrford on the seventeenth day of

September one thousand nine hundred and eighteen Before Richard Mills English Steward of the Courts of the most Honourable William Thomas Brumlow Murray of Exeter Baron of Bughley Lord of the said Manor.

John Ougden Ward
Devisee of Mary Jane
Johnson.

Be it remembered

that on the seventeenth day of September one thousand nine hundred and eighteen John Ougden Ward of 292 Union Avenue Elmwood Winnipeg in the Dominion of Canada by Fred Andrews his Attorney came before me Richard Mills English Steward of the Courts of the said Manor and represented that Mary Jane Johnson late of Calderott Spinster a Copyhold or customary tenant of this Manor died on the thirteenth day of April one thousand nine hundred and five seized in customary fee simple of the hereinafter described hereditaments within and holder of the said Manor and produced the Probate of the Will of the said Mary Jane Johnson whereby the said Mary Jane Johnson devised the said hereditaments to her Sister Emily Bostock Clarke during her life and from and after her decease to the use of the said John Ougden Ward his heirs and assigns forever. And it is further represented to me that the said Emily Bostock Clarke died on the fourth day of January one thousand nine hundred and sixteen. **Now** comes the said John Ougden Ward by his said Attorney and prays to be admitted Tenant to All that messuage or tenement with the yard garden carriage house stable Offices and outbuildings thereto belonging situate at Calderott aforesaid bounded on or towards the North-west and Northeast by property now or late of Robert Morrison or towards the Southeast by property formerly of William Hugh Wright and now of _____ and on or towards the South-west by the Uppingham and Kettering Road To which hereditaments the said Mary Jane Johnson and Charles Johnson were admitted as joint tenants on the third day of March one thousand eight hundred and ninety one under a Bargain and Sale from George Brown at the

h
F

A

C

M. J.

M.

W.

Satic

11th November 1718.

yearly rent of One farthing and of which the said Mary Jane Johnson so died seized as aforesaid **Cowston** the Lord by his said Steward granted seizin by the Rod. **Cowston** the new hereditaments aforesaid with the appurtenances unto the said John Ogden Ward and his heirs at the Will of the Lord according to the custom of the Manor by the rents suits and services therefor due and of right accustomed and he gives to the Lord for a Fine as in the margin is admitted Tenant and his Fealty is respited.

Rent. 4
Fine. 4

Examined by me,

Thomas English
Steward.

Manor of Liddington

23rd September 1918.

John Marsh Northern of Thorpe by Water appointed a Deener for Liddington in the room of Thomas Middleton deceased.

Thomas English

Steward.

The Manor of Liddington

with baldecott.

in the county of Rutland.

I John Fowler of Uppingham in the county of Rutland Gentleman, hereby acknowledge that I have this day received

Mr John Fowler

to

Mr W. W. Ward

Warrant of Satisfaction.

of and from William Wignell Ward of Braybrooke in the county of Northampton formerly of baldecott in the county of Rutland Grazier all principal money and interest owing to me on the security of a conditional Surrender made to me by the said William Wignell Ward of certain copyhold hereditaments held of the said Manor and bearing date the twenty sixth day of November, one thousand eight hundred and ninety seven and I hereby direct and require the Steward of the said Manor to enter up satisfaction of the said conditional Surrender on the Court Rolls of the said Manor and for so doing this shall be his sufficient Warrant and authority Dated this eleventh day of November one thousand nine hundred and eighteen J. Fowler.

(Step 6)

Examined by me,

Thomas English

Steward.

25th March 1919.

Involvement of Will of
Ellen Ingram Leaton

This is the Last Will and Testament of me Ellen
Ingram Leaton of Uppingham Rutland in the County of
Rutland made this twenty third day of February in the year of
our Lord one thousand nine hundred and eighteen. I hereby revoke
all Wills made by me at any time heretofore. I appoint Jasper
Frisby of Uppingham and Emma Annie Warren of 55 Old Charlton
Kent. I bequeath £10 each to ^{be} my Executors and direct that all
my debts and Funeral expenses shall be paid as soon ^{as} conveniently
may be after my decease. I give and bequeath unto my cousin
Jane Broadley the House now occupied by Mrs. Edward Thorp
also Fifty pounds. To Jane Smith and her Sister Fannie Edgson
Fanny Ingram, Mary Ingram daughters of the late George
Gamble Fifty pounds each. To Harriet Chappell One hundred
pounds and my Gold Watch and Chain if in my employ. I
bequeath the remainder of the proceeds both real and personal
estate to my cousin Emma Leaton of 7 Pershurst Road Thornton
Heath Surrey and Emma Annie Warren of 55 Church Lane Old
Charlton Kent 1/4 of unequal shares. I hereby revoke all former
Wills in Witness whereof I have hereunto set my hand this
Twenty third day of February one thousand nine hundred and
eighteen - Ellen Ingram Leaton - Signed by the said Ellen
Ingram Leaton in our presence and by us in her presence -
A. C. Cooke, Lavinia Cooke.

Examined by me,

Wm. Steward
Steward.

Mr. Jasper Frisby and
Mrs. Emma A. Warren

to

Miss Mildred May
Frisby.

Bargain & Sale

This Indenture made the twenty fifth day of March, one
thousand nine hundred and nineteen Between Jasper Frisby of
Uppingham in the County of Rutland Butcher and Emma
Annie Warren of 55 Church Lane Old Charlton in the County
of Kent the wife of Edward Warren of the same place Draughtsman
(hereinafter called "the Vendor") of the one part and Mildred May
Frisby of Uppingham aforesaid spinster (hereinafter called "the Purchaser")
of the other part. Whereas Ellen Ingram Leaton being at her death
seised of the hereditaments hereinafter described for an estate of inheritance

Proved by both Executors in
Leicester District Registry
21st Nov. 1918

17/6
1919

25th March 1919.

according to the custom of the Manor of Liddington with Baldecott in the said County of Rutland died on the twentythird day of October, one thousand nine hundred and eighteen having by her Will dated the twentythird day of February one thousand nine hundred and eighteen appointed the vendors to be her executors and Testatrix directed that all her debts and funeral expenses should be paid as soon as conveniently after her decease and after making a certain specific devise and certain pecuniary and specific bequests Testatrix bequeathed the remainder of the proceeds both real and personal estate as therein mentioned. And whereas the vendors on the twentyfirst day of November one thousand nine hundred and eighteen duly proved the said Will at the Leicester District Probate Registry. And whereas the vendors as such Executors as aforesaid have agreed to sell to the Purchaser the hereditaments hereinafter described free from incumbrances for an estate of inheritance according to the custom of the said Manor at the price of One hundred and fifty five pounds. Now this Indenture witnesseth that in pursuance of the said agreement and in consideration of the sum of One hundred and fifty five pounds now paid by the Purchaser to the vendors as such executors as aforesaid (the receipt of which sum the vendors hereby acknowledge) the vendors as Personal Representatives of the said Ellen Ingram Leaton deceased and in exercise of the power conferred on them by Section 16 of the Law of Property Amendment Act 1859 and of all other powers hereby bearing sell and appoint unto the Purchaser All that close piece or parcel of land or ground situate lying and being in Liddington aforesaid within the said Manor in a certain place or field there before the enclosure thereof called the ~~Barrow~~ formerly said to contain Two acres three roods and seventeen perches but by Ordnance Survey Two acres three roods and twenty four perches. Bounded on the Northeast by land of John Hugh Colwell and Mrs. Lucy Clift on the Southeast and Southwest by land of H. S. T. Bullock and on the Northwest by the Turnpike Road and numbered 70 on the Ordnance Survey map for the parish of Liddington aforesaid held by copy of Court Roll of the said Manor under the yearly rent of One shilling. To which the said Ellen Ingram Leaton was admitted on the twentieth day of August one thousand eight hundred and eighty five To hold unto

12th April 1919

and to the use of the Purchaser her heirs and assigns at the Will of the Lord according to the custom of the said Manor by and under the rents suits and services thereof due and of right accustomed. It is hereby certified that the transaction hereby effected does not form part of a larger transaction or of a series of transactions in respect of which the amount or value or the aggregate amount or value of the consideration exceeds five hundred pounds In witness whereof the said parties hereto have hereunto set their hands and seals the day and year first before written Jasper J. Frisby - Emma Annie Warren - Signed sealed and delivered by the said Jasper Frisby in the presence of Charles Ed. Manton Uppingham Solicitors Clerk - Signed sealed and delivered by the said Emma Annie Warren in the presence of Charles Ed. Manton Uppingham Solicitors Clerk.

Examined by me

Richard Mills

Steward.

The Manor of Liddington

with Caldercote

in the County of Rutland

The Admission of Mildred May

Frisby out of bond at Stamford on the twelfth day of April one thousand nine hundred and

Mildred May Frisby under Bargain and Sale from Jasper Frisby and Emma Annie Warren as personal Representatives of Ellen Ingram Leaton deceased

nineteen Before Richard Mills English Steward of the Courts of the Most Honorable William Thomas Brownlow Marquis of Exeter Baron of Burghley Lord of the said Manor.

Whereas

by an Indenture dated the twenty fifth day of March one thousand nine hundred and nineteen ^{made between} Jasper Frisby of Uppingham in the County of Rutland Butcher and Emma Annie Warren of 55 Church Lane, Old Charlton in the County of Kent the Wife of Edward Warren of the same place Draughtman thereafter called the Vendors of the one part and Mildred May Frisby of Uppingham aforesaid Spinster thereafter called the Purchaser of the other part the Vendors as personal Representatives of Ellen Ingram Leaton deceased and in exercise of the power conferred on them by section 16 of the Law of Property Amendment Act 1859 bargained sold and appointed the hereditaments hereinafter described unto and to the ^{use of the} Purchaser in

See
Vol
Lidd
1919

Re
Fi

customary fees simple according to the custom of the Manor by and under the rents suits and services therefor due and of right accustomed **AND** be it remembered that on the twelfth day of April, One thousand nine hundred and nineteen the said Mildred May Frisby by Fred Andrews her Attorney came before Richard Hill English Steward of the Courts of the said Manor and produced the said Bargain and Sale which she prayed might be enrolled on the Court Rolls of the Manor and the same has been enrolled accordingly and also prayed that she might be admitted Tenant to the hereditaments so bargained sold and appointed to her as aforesaid namely All that close of land at Liddington within the said Manor in a place or field there before the enclosure thereof called "the Brand" formerly said to contain two acres three roods and seventeen perches but by the Ordnance Survey two acres three roods and twenty four perches, bounded on the Northeast by land of John Hugh Colwell and Lucy Clifton the Southeast and Southwest by land of H. S. F. Bullock, and on the North West by the Turnpike Road. To which hereditaments the said Ellen Ingram Leaton was admitted Tenant on the twentieth day of August one thousand eight hundred and eighty five, as Deviser of Eliza Ingram deceased under the yearly rent of one shilling **TO HOLD** the Lord by his said Steward granted seizin by the Rod. **TO HOLD** the new hereditaments aforesaid together with the appurtenances unto the said Mildred May Frisby and her heirs at the Will of the Lord according to the custom of the Manor by the rents suits, and services therefor due and of right accustomed and she gives to the Lord for a Fine as in the margin is admitted Tenant and her fealty is respited.

Verify the Margin
 What bears a Stamp of
 Delivered Shilling and
 Six pence
 Wm. Hill
 Steward

Rent	1 ^s 0 ^d
Fine	1 ^s 0 ^d

Examined by me

Richard Hill
 Steward.

John Kirkbride

to

F. E. Hodgkinson

Power of Attorney

To all to whom these Presents shall come.

I John Kirkbride of Shingleton Michigan in the United States of America Railway Foreman send greeting.

Whereas I am residing beyond the seas and am desirous of authorizing Frank Edward Hodgkinson of Uppingham in the County of Rutland Solicitor to sell and dispose of all or any my freehold and copyhold lands, tenements and hereditaments situate in the Counties of Rutland and Northampton and particularly (but not so as to limit the generality of the foregoing power) the lands tenements and hereditaments specified in the Schedule hereto. And whereas Elizabeth James Kirkbride is entitled to an annuity of Seventy two pounds per annum charged upon my said lands tenements and hereditaments and it is expedient that provision should be made for procuring the release of the said annuity. Now know ye that I the said John Kirkbride hereby irrevocably appoint the said Frank Edward Hodgkinson to be my lawful Attorney for one year from the date hereof, for me and in my name and for my use to perform the following acts:

1. To sell and dispose of all or any of my said lands tenements and hereditaments with the appurtenances either by private contract or by public auction and either together or in separate parcels or lots for such price as to him shall seem reasonable and under such contracts and conditions of sale as he may deem necessary.
2. Upon the receipt of the consideration or purchase money for the same or any part thereof to give a good receipt therefor which receipt shall exonerate the person paying such money from seeing to the application thereof or being responsible for the loss or misapplication thereof.
3. To enter into negotiations contract or otherwise deal with the said Elizabeth James Kirkbride for the release of her said annuity upon such terms and conditions as my said Attorney shall consider expedient and in particular out of the purchase money of the said lands tenements and hereditaments or any part thereof or by mortgage charge or pledge of the same lands tenements and hereditaments or any part or parts thereof or otherwise to raise or pay such sum or sums of money as may be required by the investment

Stamp

10/-

thereof in National War Bonds or other suitable securities or otherwise to provide the said annuity or to procure the release therefrom of the said lands tenements and hereditaments or any part thereof and to make take or bring in the High Court of Justice or other competent Tribunal under Section 5 of the Conveyancing Act 1881 or otherwise all such applications actions and proceedings as may be necessary or expedient compulsorily to obtain the release or discharge of the said annuity and to pay invest or transfer all such sum or sums of money securities or investments and to pay all such costs charges and expenses as may be necessary to comply with or carry out any order decree or decision of any such Court or Tribunal.

4. To sign and seal and as my act and deed deliver any deed or instrument in writing and to pass surrenders of the said copyhold hereditaments in the said several Manors and to do every other thing whatsoever which may be necessary or proper for carrying any agreement for purchase or any such mortgage charge or pledge as aforesaid or any release of the said annuity into complete effect and execution in such manner that all my estate right title and interest in or to the said freehold and copyhold lands tenements and hereditaments with the appurtenances may be effectually and absolutely conveyed, surrendered mortgaged or charged, pledged released and assured unto and to the use of the Purchaser mortgagee or respective purchasers or mortgagees thereof his and their heirs and assigns for ever or unto such other person or persons and for such estate or estates therein and in such manner and form as he or they shall direct or appoint or circumstances shall require.

5. And I the said John Kirkbride hereby declare that all and every the receipts deeds surrenders, mortgages charges pledged matters and things which shall be by him or my said Attorney given made executed or done for the aforesaid purposes shall be as good valid and effectual to all intents and purposes whatsoever as if the same had been signed sealed and delivered given or made or done by me in my own proper person.

6. And I hereby undertake at all times to ratify whatsoever my